

A C FIXINGS LTD



Product List

Serving the Construction Industry for over 25 years

A	
Abrasive Discs	60
Abrasive Rolls	61
Adhesives	69
Alpha Wedge	12
Aluminum Foil Tape	72
Angle Brackets	46
Anker Bolts	7
Anchors	
Anker Bolts	7
chemical fixings	14 / 15
Drop In	11
Heavy Duty	9
Rawl Bolts	10
Resin	14/15
Shield Anchors	10
Sleeve Anchors	9
Through bolts	8
B	
Back Plates	64
Barrier Tape	72
Big Foot System	68
Blacksmith Drill Bit	53
Bolts	
Coach Bolts	37
H.T XoX Bolt	39
Roofing Bolt	40
Set Screw	38
Bolts	
Brenton	77
Tower	77
Boots	74
Brass Wood screw	25
Brooms	78
Buckets	71
C	
Cable bows	63
Cable Reels	76
Cable Ties	63
Cable trays	64
Carriage Bolts	37
Cartridge Tool	18
Cavity Anchor	2
Ceiling Anchor	5
Chain	74
Channel Brackets	66/67

Channel Nuts	65
Channel Support	65
Chemical Fixings	14/15
Chemical Studs	15
Chippy Screws	22
Chisels SDS	48
Chucks	53
Circle Drywall Discs	60
Circular Saw Blades	58
Coach Bolts	37
Coach Screws	36
Cobalt Hss Drill Bits	52
Concrete Screw	6
Cone Cutters	53
Countersunk Bits	53
D	
Diamond Blades	60
Diamond Core bits	49
Diamond Mini Core Bits	50
Dome Nuts	41
Drill Bits	
Blacksmith	52
Broaching	53
Cobalt HSS	53
Diamond	49/50
HSS	51
Magdrill	53
Rebar Bits	48
SDS	47
SDS Max	48
Tile & Glass	50
Wood Auger	55
Wood Flat Bit	55
Driva	2
Drop-In Anchors	11
Drywall Disc	61
Drywall Screws	30/31
Dust Bin	79
Dust Mask	73
Dust Pan & Brush	77
Dust Sheet	77
E	
Ear Defenders	73
Ear Plugs	73
Electrical Tape	72
Electricians Hole saw	54

Evolution Saw Blades	59
Expanding Foam	71
Extension Leads	76
F	
Fire Extinguishers	74
Fire-fix Clips	17
Flange Nuts	42
Frame Fixings	6
G	
Gaffer Tape	72
Galvanizing Spray	71
Gas - Pulsa Tool	16
Gate Latch	77
Glasses Safety	73
Gloves	73
Goggles Safety	73
Gripple	68
Gun Foam	71
H	
Hacksaw Blades	57
Hacksaw Blade Junior	57
Hammer Screw	3,4
Handsaw	5
Hard Hats	6
Harness Safety	74
Hasp & Staples	77
Hilti DX Type Pins & Cartridge	19
Hinges Tee	77
Holesaws	54
Hop-ups	75
HSS Drill Bits	51
Hss Cobalt Drill Bits	52
I	
Index Screws	35
Ironmongery	77
Insulation Anchors	3
Insulation Panel Fix	4
Insulation Screws	5
Insulation Washers	6
J	
Jigsaw Blade	56
Joist Hangers	45
L	
Ladders	75
Line Marker Spray	71
M	
Machine Screws	40

Magdrill Bits	53
Masking Tape	72
Masks Safety	73
Masonry Nails	4
Mini Diamond Core Bits	50
Multi Wedge	2
N	
Nail Ins	5
Nails Masonry	4
Nails Wire	44
Nuts	
Dome	41
Flange	42
Half	41
Nyloc	41
Nutserts	42
P	
Packing Shrins	35
Padlocks	74
Paint Brushes	78
Panel Adhesive	69
Panel Fix	3
Pancake Screws	32
Panel Pins	44
Paper Tape	72
Paslode Nails	20
R	
Rage Blades	51
Ramnuts	13
Rawlbolts	10
Rawlnuts	13
Rebar Bits	5
Redhead Anchors	11
Recipricating saw Blades	56
Resin Fixings	14
Restraint Straps	46
Rivets	8
Rod Hangers	7
Roofing Bolts	40
Roofing Top Building Support	68
Roundhead Wood screws	24
Rubber Nuts	13
Rubble Sacks	78
S	
Safety Wear	73,74
Saw Blades	
Circular	58

Diamond	60
Evolution	51
Hacksaw	57
Jigsaw	56
Junior Hacksaw	57
Rage	59
Recipricating	56
Screws	
Chippy	22
Cementatious Screw	32
Drywall	30/31
Insulation	4
Self Tappers	27
Stainless Steel	26
Super twin Wood screw	23
Tough board	32
Ultimate	21
Screw Cups	28
Screw Driver Bits	29
Scrim Tape	72
SDS Drill Bits	47
SDS Max Drill bits	48
SDS Points	48
Self Tapping Screws	27
Set Bolts	38
Shake proof Washers	42
Shear Nuts	41
Shield Anchors	10
Silicon	70
Site Lighting	76
Site Safe	74
Sleeve Anchor	9
Slim Deck	12
Spit Cartridge Tool	18
Spit Pulsa Tool	18
Spring Toggle	2
Spring Washer	43
Staple & Staple gun	28
Stepdrill	53
Stud Connectors	13
Studding	13
Sure twist Nails	3
T	
Table Stretcher Plate	28
Tap-con Screws	6
Taps	52

Tapes	72
Tek Screws	
Counter Sunk	34
Gash Point	35
Hex Head	33
Through Bolts	8
Threaded Rod	13
Timber Connectors	42
Timberlock Screws	35
Toggles	2
Toughboard Screw	32
TR60	12
Transformers	76
U	
Ultimate Screws	21
V	
Vine Eyes	5
Visqueen Zedek	79
W	
Washers	43
Insulation	4
Penny	43
Shake proof	43
Spring	43
Square Plate	42
WD40	71
Wedge Nuts	12
Wet & Dry Paper	61
Wing Nuts	4
Wipes	78
Wire hanger	5
Wood Bits -Auger	55
Wood Bits - Flat	55
Wire hanger	5
Wood Bits -Auger	55
Wood Bits - Flat	55
Wood Screws	
Brass	25
Chippy	22
High Proformance	21
Self Tapping	27
Stainless Steel	26
Super twin	23
Ultimate	21
Square Twist Nail	44



PLASTIC PLUGS

Description	Stock Code	Drill Bit	Screw Size
Yellow Plastic Plugs	PPY	5/5.5 MM	No.6 -8
Red Plastic Plugs	PPR	5.5/6MM	No.6 -8 -10
Brown Plastic Plugs	PPB	7/8 MM	No.10/12



NYLON PLUGS

Description	Stock Code	Drill Bit	Screw Size
6 x 30 Nylon Plugs	NP6	6MM	3.5 - 5 MM
8 x 40 Nylon Plugs	NP8	8MM	4 - 5.5 MM
10 x 50 Nylon Plugs	NP10	10MM	5 - 6 MM
12 x 60 Nylon Plugs	NP12	12MM	8 - 10 MM
14 x 70 Nylon Plugs	NP14	14MM	10 -12 MM



HAMMERSCREWS

Description	Stock Code	Drill Bit	Max. thickness to fit
6 x 40 Hammer Screw	HS640	6 MM	15 MM
6 x 60 Hammer Screw	HS660	6 MM	35 MM
6 x 80 Hammer Screw	HS680	6 MM	55 MM
8 x 60 Hammer Screw	HS860	8 MM	28 MM
8 x 80 Hammer Screw	HS880	8 MM	40 MM
8 x 100 Hammer Screw	HS8100	8 MM	60 MM
8 x 120 Hammer Screw	HS8120	8 MM	80 MM
8 x 140 Hammer Screw	HS8140	8 MM	100 MM



HAMMERSCREW A2 304 STAINLESS STEEL

Description	Stock Code	Drill Bit	Max. thickness to fit
6 x 40 St/Steel Hammer Screw	HS640SS	6 MM	15 MM
6 x 60 St/Steel Hammer Screw	HS660SS	6 MM	35 MM
8 x 60 St/Steel Hammer Screw	HS860SS	8 MM	28 MM
8 x 80 St/Steel Hammer Screw	HS880SS	8 MM	48 MM
8 x 100 St/Steel Hammer Screw	HS8100SS	8 MM	68 MM

DRIVA SELF DRILLING PLASTERBOARD ANCHOR



Description	Stock Code	Max. thickness to fit
TP12 Driva	TP12	12 MM
TF27 Driva	TP27	27 MM

STEEL CAVITY ANCHOR



Description	Stock Code	Drill Bit	Wall thickness
4/13 Cavity Anchor	CA413	7 MM	8 - 13 MM
5/13 Cavity Anchor	CA513	9 MM	5 - 13 MM
5/26 Cavity Anchor	CA526	9 MM	17 - 25 MM
6/13 Cavity Anchor	CA616	10 MM	7 - 13 MM
6/32 Cavity Anchor	CA632	10 MM	16 - 24 MM
Expanding Tool	CASET		

SPRING TOGGLES



Description	Stock Code	Drill Bit	Wall & Fixture thickness	Cavity Depth
M 5 x 50 Spring Toggle	ST550	14 MM	20 MM	30 MM
M5 x 75 Spring Toggle	ST575	14 MM	45 MM	30 MM
M5 x 100 Spring Toggle	ST5100	14 MM	70 MM	30 MM
M6 x 75 Spring Toggle	ST675	18 MM	45 MM	30 MM
M5 Toggle Head Only	ST5	14 MM		30 MM
M6 Toggle Head Only	ST6	18 MM		30 MM
M8 Toggle Head Only	ST8	22 MM		40 MM
M10 Toggle Head Only	ST10	25 MM		40 MM

ALUMINIUM POP RIVET



Description	Stock Code	Drill Bit	GRIP RANGE
3.2 x 10 Aluminium Pop Rivet	PR3210	3.3 MM	4.5 - 6 MM
3.2 x 12 Aluminium Pop Rivet	PR3212	3.3 MM	6.5 - 8.5 MM
3.2 x 16 Aluminium Pop Rivet	PR3216	3.3 MM	10.5 - 12.5 MM
4.0 x 8 Aluminium Pop Rivet	PR48	4.1 MM	1.5 - 4.5 MM
4.0 x 10 Aluminium Pop Rivet	PR410	4.1 MM	3.5 - 6 MM
4.0 x 12 Aluminium Pop Rivet	PR412	4.1 MM	5.5 - 7.5 MM
4.0 x 14 Aluminium Pop Rivet	PR414	4.1 MM	7.5 - 10 MM
4.0 x 16 Aluminium Pop Rivet	PR416	4.1 MM	9.5 - 11.5 MM
4.8 x 8 Aluminium Pop Rivet	PR488	4.9 MM	0.5 - 4.5 MM
4.8 x 10 Aluminium Pop Rivet	PR4810	4.9 MM	3 - 6 MM
4.8 x 14 Aluminium Pop Rivets	PR4814	4.9 MM	7 - 10 MM
4.8 x 20 Aluminium Pop Rivets	PR4820	4.9 MM	13 - 15 MM
4.8 x 25 Aluminium Pop Rivets	PR4825	4.9 MM	17 - 20 MM

PANEL FIX INSULATION ANCHORS

Description	Stock Code	Drill Bit	Material Thickness
M8 X 50 PANEL FIX	EVPF50	8 MM	10 - 20 MM
M8 X 70 PANEL FIX	EVPF70	8 MM	10 - 40 MM
M8 X 90 PANEL FIX	EVPF90	8 MM	10 - 60 MM
M8 X 110 PANEL FIX	EVPF110	8 MM	10 - 80MM
M8 X 130 PANEL FIX	EVPF130	8 MM	10 -100 MM

UNIVERSAL INSULATION ANCHOR (WITH CENTRE PIN)

Description	Stock Code	Drill Bit	Material Thickness
10 X 60 INSULATION ANCHOR	INS1060	10 MM	10 -30 MM
10 X 90 INSULATION ANCHOR	INS1090	10 MM	40 - 60 MM
10 X 110 INSULATION ANCHOR	INS10110	10 MM	70 -80 MM
10 X 130 INSULATION ANCHOR	INS10130	10 MM	90 -100 MM
10 X 150 INSULATION ANCHOR	INS10150	10 MM	110 -120 MM
10 X 175 INSULATION ANCHOR	INS10175	10 MM	135 - 145 MM
10 X 195 INSULATION ANCHOR	INS10195	10 MM	155 - 165 MM
10 X 215 INSULATION ANCHOR	INS10215	10 MM	175 - 185 MM
10 X 235 INSULATION ANCHOR	INS10235	10 MM	195 - 205 MM

STAINLESS STEEL INSULATION ANCHOR

Description	Stock Code	Drill Bit	Material Thickness
M8 X 80 ST / ST INSULATION ANCHOR	INS880SS	8 MM	30 MM
M8 X 110 ST / ST INSULATION ANCHOR	INS8110SS	8 MM	60 MM
M8 X 140 ST / ST INSULATION ANCHOR	INS8140SS	8 MM	90 MM

GALVANISED INSULATION ANCHOR

Description	Stock Code	Drill Bit	Material Thickness
M8 X 80 GALV INSULATION ANCHOR	INS880G	8 MM	30 MM
M8 X 110 GALV INSULATION ANCHOR	INS8110G	8 MM	60 MM
M8 X 140 GALV INSULATION ANCHOR	INS8140G	8 MM	90 MM
M8 X 170 GALV INSULATION ANCHOR	INS8170G	8 MM	120 MM
M8 X 200 GALV INSULATION ANCHOR	INS8200G	8 MM	150 MM

SURETWIST NAILS FOR INSULATION TO TIMBER

Description	Stock Code	Material Thickness
M8 X 90 INSULATION NAIL 20 MM HEAD	SURE90	55 MM
M8 X 135 INSULATION NAIL 20 MM HEAD	SURE135	100 MM
M8 X 165 INSULATION NAIL 20 MM HEAD	SURE165	130 MM
M8 X 195 INSULATION NAIL 20 MM HEAD	SURE195	160 MM
M8 X 220 INSULATION NAIL 20 MM HEAD	SURE220	185 MM

SELF DRILLING INSULATION SCREW 0.7 - 2 MM STEEL AND SUITABLE FOR TIMBER



Description	Stock Code
4.8 x 60 MM INSULATION SCREW	ETKR60
4.8 x 80 MM INSULATION SCREW	ETKR80
4.8 x 100 MM INSULATION SCREW	ETKR100
4.8 x 120 MM INSULATION SCREW	ETKR120
4.8 x 140 MM INSULATION SCREW	ETKR140
4.8 x 160 MM INSULATION SCREW	ETKR160
4.8 x 180 MM INSULATION SCREW	ETKR180
4.8 x 200 MM INSULATION SCREW	ETKR200
4.8 x 220 MM INSULATION SCREW	ETKR220
4.8 x 240 MM INSULATION SCREW	ETKR240
4.8 x 260 MM INSULATION SCREW	ETKR260
4.8 x 280 MM INSULATION SCREW	ETKR280
4.8 x 300 MM INSULATION SCREW	ETKR300

RETAINING WASHERS FOR SECURING INSULATION TO TIMBER AND STEEL (IN CONJUNCTION WITH SCREWS)



Description	Stock Code
46 MM RETAINING WASHER 5 MM RECESS	RW5
46 MM RETAINING WASHER 18 MM RECESS	RW18
50 MM RETAINING WASHER 35 MM RECESS	RW35
50 MM RETAINING WASHER 60 MM RECESS	RW50

MASONRY NAILS HEAVY GAUGE



Description	Stock Code
50mm Heavy Masonry Nail	MNH50
60mm Heavy Masonry Nail	MNH60
70mm Heavy Masonry Nail	MNH70
80mm Heavy Masonry Nail	MNH80
100mm Heavy Masonry Nail	MNH100

MASONRY NAILS MEDIUM GAUGE



Description	Stock Code
25mm Medium Masonry Nail	MNM25
30mm Medium Masonry Nail	MNM30
40mm Medium Masonry Nail	MNM40
50mm Medium Masonry Nail	MNM50
60mm Medium Masonry Nail	MNM60



METAL NAIL IN ANCHOR

Description	Stock Code	Drill Bit	Max. thickness to fix
6 X 30 Metal Nail In	MN630	6 MM	5 MM
6 x 40 Metal Nail In	MN640	6 MM	15 MM
6 x 50 Metal Nail In	MN650	6 MM	25 MM
6 X 65 Metal Nail In	MN665	6 MM	40 MM



CEILING ANCHORS

Description	Stock Code	Drill Bit	Max. thickness to fix
6 x 40 CEILING ANCHORS	DBZ40	6 MM	5 MM
6 X 65 CEILING ANCHORS	DBZ65	6 MM	30 MM



WIRE HANGERS

Description	Stock Code	Drill Bit
M6 Wire Hangers (for concrete)	WH6	6mm



VINE EYES

Description	Stock Code
75MM Vine Eyes (for timber)	VE075
100MM Vine Eyes (for timber)	VE100

HEX HEAD NYLON FRAME FIXING

Description	Stock Code	Drill Bit	Max. thickness to fix
10 x 60 Frame Anchor (Hex Head)	NFA1060H	10MM	10 MM
10 x 80 Frame Anchor (Hex Head)	NFA1080H	10MM	30 MM
10 x 100 Frame Anchor (Hex Head)	NFA10100H	10MM	50 MM

TORX HEAD NYLON FRAME FIXING

Description	Stock Code	Drill Bit	Max. thickness to fit
10 x 80 Frame Anchor	NFA1080	10 MM	30 MM
10 x 100 Framer Anchor	NFA10100	10 MM	50 MM
10 x 115 Frame Anchor	NFA10115	10 MM	65 MM
10 x 135 Frame Anchor	NFA10135	10 MM	85 MM
10 x 160 Frame Anchor	NFA10160	10 MM	110 MM

CONCRETE SCREWS (TORX DRIVE)

Description	Stock Code	Drill Bit	Max. thickness to fit
7.5 x 72 Csk Torx Concrete Screw	Con72	M6/6.5	35 MM
7.5 x 82 Csk Torx Concrete Screw	Con82	M6/6.5	40 MM
7.5 x 92 Csk Torx Concrete Screw	Con92	M6/6.5	45 MM
7.5 x 102 Csk Torx Concrete Screw	Con102	M6/6.5	50 MM
7.5 x 112 Csk Torx Concrete Screw	Con112	M6/6.5	60 MM
7.5 x 122 Csk Torx Concrete Screw	Con122	M6/6.5	70 MM
7.5 x 132 Csk Torx Concrete Screw	Con132	M6/6.5	80 MM
7.5 x 142 Csk Torx Concrete Screw	Con142	M6/6.5	90 MM
7.5 x 152 Csk Torx Concrete Screw	Con152	M6/6.5	100 MM
7.5 x 162 Csk Torx Concrete Screw	Con162	M6/6.5	115 MM
7.5 x 182 Csk Torx Concrete Screw	Con182	M6/6.5	130 MM

TAPCON CONCRETE SCREW (countersunk or hex head blue)

Description	stock code csk	stock code hex head	Drill Bit	Max. thickness to fit
5 x 32 mm	3f32	3H32	4 MM	0 -7 MM
5 x 45 mm	3f45	3H45	4 MM	5 -20 MM
5 x 57 mm	3f57	3H57	4 MM	17 -32 MM
5 x 70 mm	3f70	3H70	4 MM	30 - 45 MM
5 x 82 mm	3f82	3H82	4 MM	42 -57 MM
5 x 100mm	3f100	3H100	4 MM	60 - 75 MM
6 X 32 MM	4F32	4H32	5 MM	0 -7 MM
6 X 45 MM	4F45	4H45	5 MM	5 -20 MM
6 X 57 MM	4F57	4H57	5 MM	17 -32 MM
6 X 70 MM	4F70	4H70	5 MM	30 - 45 MM
6 X 82 MM	4F82	4H82	5 MM	42 -57 MM
6 X 100 MM	4F100	4H100	5 MM	60 -75 MM
6 X 125 MM	4F125	N/A	5 MM	85-100 MM

ANKERBOLT - SELF TAPPING CONCRETE ANCHOR

Description	Stock Code	Drill Bit	Max. thickness to fit
M10 X 60 ANKERBOLT	JAB081060	8MM	20MM
M10 X 75 ANKERBOLT	JAB081075	8MM	35MM
M10 X 100 ANKERBOLT	JAB0810100	8MM	60MM
M10 X 130 ANKERBOLT	JAB0810130	8MM	90MM
M10 X 150 ANKERBOLT	JAB0810150	8MM	110MM
M12 X 60 ANKERBOLT	JAB101260	10MM	10MM
M12 X 75 ANKERBOLT	JAB101275	10MM	25MM
M12 X 100 ANKERBOLT	JAB1012100	10MM	50MM
M12 X 130 ANKERBOLT	JAB1012130	10MM	80MM
M12 X 150 ANKERBOLT	JAB1012150	10MM	100MM
M14 X 75 ANKERBOLT	JAB121475	12MM	15MM
M14 X 100 ANKERBOLT	JAB1214100	12MM	40MM
M14 X 130 ANKERBOLT	JAB1214130	12MM	70MM
M14 X 150 ANKERBOLT	JAB1214150	12MM	90MM
M14 X 200 ANKERBOLT	JAB1214200	12MM	140MM
M16 X 75 ANKERBOLT	JAB141675	14MM	5MM
M16 X 100 ANKERBOLT	JAB1416100	14MM	30MM
M16 X 130 ANKERBOLT	JAB1416130	14MM	60MM
M16 X 150 ANKERBOLT	JAB1416150	14MM	80MM
M16 X 200 ANKERBOLT	JAB1416200	14MM	130MM
M18 X 100 ANKERBOLT	JAB1618100	16MM	20MM
M18 X 150 ANKERBOLT	JAB1618150	16MM	70MM
M18 X 200 ANKERBOLT	JAB1618200	16MM	120MM

SELF TAPPING CONCRETE ROD HANGERS

Description	Stock Code	Drill Bit
7.5 X 35MM TAPCON ROD HANGER	TAPRODM8	6MM
7.5 X 35MM TAPCON ROD HANGER	TAPRODM10	6MM

ANKERBOLT ROD HANGER

Description	Stock Code	Drill Bit
DUAL THREADED ANKERBOLT ROD HANGER	ANKERRODM810	6MM

THROUGH BOLT ANCHORS

Description	Stock Code	Drill Bit	Max. thickness to fit
M6 - 45 Stud Anchor	TB645	6MM	5MM
M6 - 55 Stud Anchor	TB655	6MM	20MM
M6 - 85 Stud Anchor	TB685	6MM	50MM
M8 - 50 Stud Anchor	TB850	8MM	5MM
M8 - 65 Stud Anchor	TB865	8MM	20MM
M8 - 90 Stud Anchor	TB890	8MM	40MM
M8 - 130 Stud Anchor	TB130	8MM	80MM
M10 - 60 Stud Anchor	TB1060	10MM	5MM
M10 - 75 Stud Anchor	TB1070	10MM	15MM
M10 - 95 Stud Anchor	TB1095	10MM	36MM
M12 - 80 Stud Anchor	TB1280	12MM	5MM
M12 - 140 Stud Anchor	TB12140	12MM	65MM
M12 - 180 Stud Anchor	TB12180	12MM	105MM
M12 - 220 Stud Anchor	TB12220	12MM	145MM
M16 - 90 Stud Anchor	TB1690	16MM	5MM
M16 - 125 Stud Anchor	TB16125	16MM	30MM
M16 - 170 Stud Anchor	TB16170	16MM	75MM
M20 - 120 Stud Anchor	TB20120	20MM	10MM
M20 - 160 Stud Anchor	TB20160	20MM	50MM
M20 - 215 Stud Anchor	TB20215	20MM	105MM



STAINLESS STEEL THROUGH BOLT ANCHOR

Description	Stock Code	Drill Bit	Max. thickness to fit
M6 x 55 St/St Stud Anchor	TB655SS	6MM	5 - 15 MM
M8 x 50 St/St Stud Anchor	TB850SS	8MM	5MM
M8 x 70 St/St Stud Anchor	TB870SS	8MM	20MM
M8 x 90 St/St Stud Anchor	TB890SS	8MM	40MM
M10 x 60 St/St Stud Anchor	TB1060SS	10MM	5MM
M10 x 95 St/St Stud Anchor	TB1095SS	10MM	35MM
M12 x 80 St/St Stud Anchor	TB1280SS	12MM	5MM
M12 x 100 St/St Stud Anchor	TB12100SS	12MM	25MM
M12 x 140 St/St Stud Anchor	TB12140SS	12MM	65MM
M16 x 90 St/St Stud Anchor	TB1690SS	16MM	5MM
M16 x 125 St/St Stud Anchor	TB16125SS	16MM	30MM
M16 x 175 St/St Stud Anchor	TB16175SS	16MM	75MM
M20 x 120 St/St Stud Anchor	TB20120SS	20MM	10MM
M20 x 160 St/St Stud Anchor	TB20160SS	20MM	50MM



THROUGH BOLT ANCHORS - Galvanised

Description	Stock Code	Drill Bit	Thickness to fit
M8 - 70 Stud Anchor	TB870G	8MM	20MM
M8 - 90 Stud Anchor	TB890G	8MM	40MM
M8 - 130 Stud Anchor	TB130G	8MM	80MM
M10 - 75 Stud Anchor	TB1070G	10MM	15MM
M10 - 95 Stud Anchor	TB1095G	10MM	25MM
M12 - 80 Stud Anchor	TB1280G	12MM	5MM
M12 - 140 Stud Anchor	TB12140G	12MM	65MM
M12 - 180 Stud Anchor	TB12180G	12MM	105MM
M12 - 220 Stud Anchor	TB12220G	12MM	145MM
M16 - 10 Stud Anchor	TB16100G	16MM	5MM
M16 - 125 Stud Anchor	TB16125G	16MM	30MM
M16 - 170 Stud Anchor	TB16170G	16MM	53MM



SLEEVE ANCHOR BZP BOLT HEAD



Description	Stock Code	Drill Bit	Max. thickness to fit
M8 X 40 BOLT HEAD SLEEVE ANCHOR	SA840B	8MM	2MM
M8 X 70 BOLT HEAD SLEEVE ANCHOR	SA870B	8MM	25MM
M8 X 90 BOLT HEAD SLEEVE ANCHOR	SA890B	8MM	45MM
M10 X 45 BOLT HEAD SLEEVE ANCHOR	SA1045B	10MM	5MM
M10 X 55 BOLT HEAD SLEEVE ANCHOR	SA1055B	10MM	15MM
M10 X 80 BOLT HEAD SLEEVE ANCHOR	SA1080B	10MM	30MM
M10 X 100 BOLT HEAD SLEEVE ANCHOR	SA10100B	10MM	50MM
M12 X 60 BOLT HEAD SLEEVE ANCHOR	SA1260B	12MM	5MM
M12 X 80 BOLT HEAD SLEEVE ANCHOR	SA1280B	12MM	20MM
M12 X 100 BOLT HEAD SLEEVE ANCHOR	SA12100B	12MM	40MM
M12 X 125 BOLT HEAD SLEEVE ANCHOR	SA12125B	12MM	65MM
M16 X 65 BOLT HEAD SLEEVE ANCHOR	SA1665B	16MM	5MM
M16 X 100 BOLT HEAD SLEEVE ANCHOR	SA16100B	16MM	40MM

SLEEVE ANCHOR BZP



Description	Stock Code	Drill Bit	Max. thickness to fit
M8 x 65 Sleeve Anchor	SA865	8MM	30MM
M10 x 50 Sleeve Anchor	SA1050	10MM	5MM
M10 x 77 Sleeve Anchor	SA1077	10MM	30MM
M10 x 100 Sleeve Anchor	SA10100	10MM	50MM
M12 x 75 Sleeve Anchor	SA1275	12MM	20MM
M12 x 100 Sleeve Anchor	SA12100	12MM	50MM
M12 x 130 Sleeve Anchor	SA12130	12MM	65MM
M16 x 65 Sleeve Anchor	SA1665	16MM	10MM
M16 x 111 Sleeve Anchor	SA16111	16MM	50MM
M16 x 147 Sleeve Anchor	SA16147	16MM	80MM

HEAVY DUTY COUNTERSUNK ANCHORS



Description	Stock Code	Drill Bit	Max. thickness to fit
M10 X 70 HEAVY DUTY CSK ANCHOR	SLSK1010	10MM	10MM
M10 X 85 HEAVY DUTY CSK ANCHOR	SLSK1025	10MM	25MM
M10 X 105 HEAVY DUTY CSK ANCHOR	SLSK1045	10MM	45MM
M12 X 80 HEAVY DUTY CSK ANCHOR	SLSK1210	12MM	10MM
M12 X 95 HEAVY DUTY CSK ANCHOR	SLSK1225	12MM	25MM
M12 X 120 HEAVY DUTY CSK ANCHOR	SLSK1250	12MM	50MM
M15 X 95 HEAVY DUTY CSK ANCHOR	SLSK1510	15MM	10MM
M15 X 110 HEAVY DUTY CSK ANCHOR	SLSK1525	15MM	25MM
M15 X 135 HEAVY DUTY CSK ANCHOR	SLSK1550	15MM	50MM
M18 X 115 HEAVY DUTY CSK ANCHOR	SLSK1820	18MM	20MM
M18 X 135 HEAVY DUTY CSK ANCHOR	SLSK1840	18MM	40MM

SHIELD ANCHOR LOOSE BOLT



Description	Stock Code	Drill Bit	Max. thickness to fit
LB 6 - 10 Shield Anchor	SH610	12MM	10MM
LB 6 - 25 Shield Anchor	SH625	12MM	25MM
LB 8 - 10 Shield Anchor	SH810	14MM	10MM
LB 8 - 25 Shield Anchor	SH825	14MM	25MM
LB 8 - 40 Shield Anchor	SH840	14MM	40MM
LB 10 - 10 Shield Anchor	SH1010	16MM	10MM
LB 10 - 25 Shield Anchor	SH1025	16MM	25MM
LB 10 - 50 Shield Anchor	SH1050	16MM	50MM
LB 12 - 10 Shield Anchor	SH1225	20MM	10MM
LB 12 - 25 Shield Anchor	SH1225	20MM	25MM
LB 12 - 60 Shield Anchor	SH1260	20MM	60MM
LB 16 - 15 Shield Anchor	SH1615	24MM	15MM
LB 16 - 30 Shield Anchor	SH1630	24MM	30MM
LB 16 - 60 Shield Anchor	SH1660	24MM	60MM

SHIELDS ONLY



Description	Stock Code	DRILL BIT
M6 Shield	SH6	12MM
M8 Shield	SH8	14MM
M10 Shield	SH10	16MM
M12 Shield	SH12	20MM
M16 Shield	SH16	24MM

SHIELD ANCHOR HOOK AND EYE BOLTS



Description	Stock Code	Drill Bit
M6 Shield Eye Bolt	SH6E	12MM
M8 Shield Eye Bolt	SH8E	14MM
M10 Shield Eye Bolt	SH10E	16MM
M12 Shield Eye Bolt	SH12E	20MM
M6 Shield Hook Bolt	SH6H	12MM
M8 Shield Hook Bolt	SH8H	14MM
M10 Shield Hook Bolt	SH10H	16MM
M12 Shield Hook Bolt	SH12H	20MM

HOOKS AND EYES ONLY

Description	Stock Code
M6 HOOK ONLY	HOOK6
M8 HOOK ONLY	HOOK8
M10 HOOK ONLY	HOOK10
M12 HOOK ONLY	HOOK12

Description	Stock Code
M6 FORGED EYE	EYE6
M8 FORGED EYE	EYE8
M10 FORGED EYE	EYE10
M12 FORGED EYE	EYE12



FEMALE THREAD DROP IN ANCHOR

Description	Stock Code	Drill Bit	Thread Length	Drill Depth
M6 Drop In Anchor	DI6	M8	13MM	32MM
M8 Drop In Anchor	DI8	M10	13MM	32MM
M10 Drop In Anchor	DI10	M12	15MM	42MM
M12 Drop In Anchor	DI12	M15	21MM	53MM
M16 Drop In Anchor	DI16	M20	28MM	70MM



SETTING TOOL

Description	Stock Code
M6 Setting Tool	DISET6
M8 Setting Tool	DISET8
M10 Setting Tool	DISET10
M12 Setting Tool	DISET12
M16 Setting Tool	DISET16



DROP IN ANCHOR A14 316 STAINLESS STEEL

Description	Stock Code	Drill Bit	Thread Length	Drill Depth
M6 St/St Drop In Anchor	DI6SS	M8	13MM	32MM
M8 St/St Drop In Anchor	DI8SS	M10	13MM	32MM
M10 St/St Drop In Anchor	DI10SS	M12	15MM	42MM
M12 St/St Drop In Anchor	DI12SS	M15	21MM	53MM
M16 St/St Drop In Anchor	DI16SS	M20	28MM	70MM



LIPPED DROP IN ANCHORS

Description	Stock Code	Drill Bit
M6 LIPPED DROP IN ANCHOR	DI6L	8MM
M8 LIPPED DROP IN ANCHOR	DI8L	10MM
M10 X 30MM LIPPED DROP IN ANCHOR	DI1030L	12MM
M10 X 40MM LIPPED DROP IN ANCHOR	DI1040L	12MM
M12 LIPPED DROP IN ANCHOR	DI12L	15MM
M16 LIPPED DROP IN ANCHOR	DI16L	20MM



SCAFFOLD RING BOLT

Description	Stock Code
M16 SCAFFOLD RING BOLT	SCAFRB

WEDGE NUTS FOR RICHARD LEES SUPER HOLORIB AND RD FOR RIBDECK 60 STEEL DECKING PROFILES



Description	Stock Code	Thread Size
M6 Wedge Nut SH	WNSH6	M6
M8 Wedge Nut SH	WNSH8	M8
M10 Wedge Nut SH	WNSH10	M10
M6 Wedge Nut RD60	WNRD6	M6
M8 Wedge Nut RD60	WNRD8	M8
M10 Wedge Nut RD60	WNRD10	M10



ALPHA WEDGE FOR RICHARD LEES STEEL DECKING RIBDECK AL , E60 AND E80 STEEL DECKING PROFILES

Description	Stock Code	Thread Size
M6 ALPHA WEDGE	AW6	M6
M8 ALPHA WEDGE	AW8	M8
M10 ALPHA WEDGE	AW10	M10



MULTI WEDGE 2 FOR KINGSPAN MD60 AND MD80 STEEL DECKING PROFILES

Description	Stock Code	Thread Size
MULTI WEDGE 2 M6	MW6	M6
MULTI WEDGE 2 M8	MW8	M8
MULTI WEDGE 2 M10	MW10	M10



TYPE TR60 FOR STRUCTURAL METAL DECK TR60 AND TR80 PROFILES

Description	Stock Code	Thread Size
TR60 M6	TR606	M6
TR60 M8	TR608	M8
TR60 M10	TR6010	M10



TYPE SD2 SLIMDECK 2 WEDGE FOR CORUS CF225 SLIMDECK PROFILES

Description	Stock Code	Thread Size
SLIMDECK2 M6	SD26	M6
SLIMDECK 2 M8	SD28	M8
SLIMDECK2 M10	SD210	M10



ZINC PLATED STUDDING

Description	Stock Code
M6 Bzp Studding	ST006
M8 Bzp Studding	ST008
M10 Bzp Studding	ST010
M12 Bzp Studding	ST012
M16 Bzp Studding	ST016
M20 Bzp Studding	ST020

Also available in Self-Colour, Stainless Steel, Brass & High Tensile



ZINC PLATED STUDDING CONNECTORS

Description	Stock Code
M6 Bzp Studding Connector	TRC06
M8 Bzp Studding Connector	TRC08
M10 Bzp Studding Connector	TRC10
M12 Bzp Studding Connector	TRC12
M16 Bzp Studding Connector	TRC16
M20 Bzp Studding Connector	TRC20



RUBBER NUTS

Description	Stock Code	Drill Bit	Wall Thickness
M6 x 15 Ramnut 16mm Long 13mm Hole	RN0615	13MM	0 - 2 MM
M6 x 25 Ramnut 26mm Long 13mm Hole	RN0625	13MM	3 - 13 MM
M8 x 25 Ramnut 28mm Long 16mm Hole	RN0825	18MM	6 - 15 MM
M8 x 50 Ramnut 50mm Long 18mm Hole	RN0850	18MM	25 - 35 MM
M10 x 55 Ramnut 55mm Long 20mm Hole	RN1055	20MM	25 - 35 MM
M12 x 75 Ramnut 80mm Long 24mm Hole	RN1275	24MM	33 - 45 MM

SPIT C MIX PLUS POLYESTER STYRENE FREE RESIN SUITABLE FOR MEDIUM APPLICATIONS

Description	Stock Code	
300 ML CARTRIDGE	CMIX300	Standard Mastic Gun
380 ML CARTRIDGE	CMIX380	Specific Application Gun Required
APPLICATOR FOR 380ML	RESG	

SPIT EPOMAX HIGH PERFORMANCE VINYLESTER RESIN

Description	Stock Code	
EPOMAX 150ML CARTRIDGE	EPO150	Standard Mastic Gun
EPOMAX 380ML CARTRIDGE	EPO380	Specific Application Gun Required
APPLICATOR FOR 380ML	RESG	

SPIT EPCON C3 EXTREME PERFORMANCE EPOXY RESIN

Description	Stock Code	
EPCON C8 450ML CARTRIDGE	EPCON	Specific Application Gun Required
EPCON INJECTION TOOL	EPCONG	

FISCHER FIS V HYBRID VINYLESTER RESIN

Description	Stock Code	
FIS V 360 S CARTRIDGE	FIS360	Specific Application Gun Required
FIS AM APPLICATOR GUN	FISAM	

FISCHER FIP RESIN POLYESTER RESIN

Description	Stock Code	
FIP C 700 380ML CARTRIDGE	FIP700	Specific Application Gun Required
FIP300 SF 300 ML CARTRIDGE	FIP300	Fits Standard Mastic Gun
FIP 150 SF 150 ML CARTRIDGE	FIP150	Fits Standard Mastic Gun
APPLICATOR GUN FOR 380ML	RESG	

DEWALT RESIN

Description	Stock Code	
PV 45 - PRO POLYESTER STYRENE FREE RESIN 300 ML CARTRIDGE	PV45	Fits Standard Mastic Gun
AC 100 - PRO VINYLESTER STYRENE FREE 300 ML CARTRIDGE	AC100300	Fits Standard Mastic Gun



CHEMICAL RESIN ANCHORS

Description	Stock Code	Drill Bit	Hole Depth
M8 Chemical Resin Capsule	CAP8	10MM	80MM
M10 Chemical Resin Capsule	CAP10	12MM	90MM
M12 Chemical Resin Capsule	CAP12	14MM	110MM
M16 Chemical Resin Capsule	CAP16	18MM	125MM
M20 Chemical Resin Capsule	CAP20	25MM	170MM
M24 Chemical Resin Capsule	CAP24	28MM	210MM

THREADED STUDS ZINC COATED AND PASSIVATED

Description	Stock Code	Drill Bit	Size	Max. thickness to fix
M8 Bzp Chemical Anchor Stud	CSTUD8	10MM	M8 X 110	15MM
M10 Bzp Chemical Anchor Stud	CSTUD10	12MM	M10 X 130	20MM
M12 Bzp Chemical Anchor Stud	CSTUD12	14MM	M12 X 160	25MM
M16 Bzp Chemical Anchor Stud	CSTUD16	18MM	M16 X190	35MM
M20 Bzp Chemical Anchor Stud	CSTUD20	25MM	M20 X 260	65MM
M24 Bzp Chemical Anchor Stud	CSTUD24	28MM	M24 X 300	63MM

THREADED STUDS STAINLESS STEEL

Description	Stock Code	Drill Bit	Size	Max. thickness to fix
M8 St/St Chemical Stud	CSTUD8SS	10MM	M8 X 110	15MM
M10 St/St Chemical Stud	CSTUD10SS	12MM	M10 X 130	20MM
M12 St/St Chemical Stud	CSTUD12SS	14MM	M12 X 160	25MM
M16 St/St Chemical Stud	CSTUD16SS	18MM	M16 X190	35MM
M20 St/St Chemical Stud	CSTUD20SS	25MM	M20 X 260	65MM
M24 St/St Chemical Stud	CSTUD24SS	28MM	M24 X 300	63MM

INTERNAL THREADED SOCKETS (FOR STAINLESS STEEL ADD SS TO END OF CODE) FOR CHEMICAL RESIN

Description	Stock Code	Drill Bit	Thread Length
M8 X 90 INTERNAL THREADED SOCKET	ITS8	14MM	25MM
M10 X 90 INTERNAL THREADED SOCKET	ITS10	20MM	30MM
M12 X 90 INTERNAL THREADED SOCKET	ITS12	24MM	35MM
M16 X 125 INTERNAL THREADED SOCKET	ITS16	28MM	50MM

PLASTIC SLEEVES FOR HOLLOW BASED MATERIALS

Description	Stock Code	To suit stud diameter
PLASTIC SLEEVE M12 X 45MM	PRS68	M6 - 8
PLASTIC SLEEVE M15 X 85MM	PRS810S	M8 - 10
PLASTIC SLEEVE M15 X 130MM	PRS810L	M8 - 10
PLASTIC SLEEVE M20 X 85MM	PRS1012	M10 - 12

ACCESSORIES FOR CHEMICAL ANCHORS

Description	Stock Code
BLOW OUT PUMP	PUMP
SPARE NOZZLES	NOZ
FLEXIBLE NOZZLE EXTENSION 13MM X 1 M	NOZEXF
RIGID NOZZLE EXTENSION 9MM X 1M	NOZEXR
WIRE BRUSH	WIREBRUSH



PULSA CORDLESS GAS NAILER

SPIT PULSA 800P CORDLESS GAS NAILER FOR DRYWALL AND GENERAL CONSTRUCTION

SPIT PULSA 800E CORDLESS GAS NAILER FOR ELECTRICAL CABLE AND CONDUIT MANAGEMENT



SPIT PULSA PINS BOXED 500s C/W GAS C9 PINS FOR STANDARD CONCRETE

Description	Stock Code	Length	Collation
C620	800C620	20MM	BLACK
C625	800C625	25MM	BLACK
C630	800C630	30MM	BLACK
C635	800C635	35MM	BLACK
C640 FH	800C640	40MM	WHITE



SPIT PULSA PINS BOXED 500s C/W GAS HC6 PINS FOR HARD CONCRETE AND STEEL

Description	Stock Code	Length	Collation
HC615	800HC615	15MM	ORANGE
HC617	800HC617	17MM	ORANGE
HC622	800HC622	22MM	ORANGE
HC627	800HC627	27MM	ORANGE
HC632	800HC632	32MM	ORANGE



SPIT PULSA PINS BOXED 500s C/W GAS HC6 PINS WITH FLUSH HEAD FOR HARD CONCRETE AND STEEL

Description	Stock Code	Length	Collation
HC6 15FH	800HC615FH	15MM	WHITE
HC6 17FH	800HC617FH	17MM	WHITE
HC6 22FH	800HC622FH	22MM	WHITE
HC6 27FH	800HC627FH	27MM	WHITE



SPIT PULSA PINS BOXED 500s C/W GAS CG6 PINS SOFT WASHERED FOR STANDARD CONCRETE SINGLE SHOT ONLY

Description	Stock Code	Length	Collation	
HCG615	800HCG615	15MM	WHITE	STEEL ONLY
HCG622	800HCG622	22MM	WHITE	STEEL ONLY
CG620	800CG620	20MM	WHITE	
CG625	800CG625	25MM	WHITE	
CG630	800CG630	30MM	WHITE	
CG635	800CG635	35MM	WHITE	



E CLIP CONDUIT CLIP

Description	Stock Code
GREY 16MM CONDUIT CLIP	ECLIP16
GREY 20MM CONDUIT CLIP	ECLIP20
GREY 25MM CONDUIT CLIP	ECLIP25
GREY 32MM CONDUIT CLIP	ECLIP32
GREY 40MM CONDUIT CLIP	ECLIP40
GREY 50MM CONDUIT CLIP	ECLIP50
BLACK 20MM CONDUIT CLIP	ECLIP20B



P CLIP FOR CONDUIT AND PIPEWORK AVAILABLE PLASTIC AND STEEL

Description Plastic	Stock Code	Description Steel	Stock Code	Stock Code
GREY SINGLE P CLIP 16MM	PCLIP16	STEEL SINGLE P CLIP 8MM	PCLIP8S	
GREY SINGLE P CLIP 18MM	PCLIP18	STEEL SINGLE P CLIP 10MM	PCLIP10S	
GREY SINGLE P CLIP 20MM	PCLIP20	STEEL SINGLE P CLIP 16MM	PCLIP16S	
GREY SINGLE P CLIP 22MM	PCLIP22	STEEL SINGLE P CLIP 20MM	PCLIP20S	
GREY SINGLE P CLIP 25MM	PCLIP25	STEEL SINGLE P CLIP 22MM	PCLIP22S	
GREY DOUBLE P CLIP 16MM	PCLIP16D	STEEL SINGLE P CLIP 25MM	PCLIP25S	
GREY DOUBLE P CLIP 20MM	PCLIP20D	STEEL SINGLE P CLIP 28MM	PCLIP28S	
GREY DOUBLE P CLIP 22MM	PCLIP22D	STEEL SINGLE P CLIP 32MM	PCLIP32S	



CLIP ELEC ALL PURPOSE CABLE TIE CLIP

Description	Stock Code
CLIELEC	011203



CABLE BOW FIXING

Description	Stock Code	Cable Capacity	Wire Guide
SINGLE CABLE BOW	SPITKB8	8 CABLES	3 CORE X 1.5 MM ²
DOUBLE CABLE BOW	SPITKB16	16 CABLES	3 CORE X 1.5 MM ²
SINGLE CABLE BOW FIRE RETARDANT	SPITKB8F	8 CABLES	3 CORE X 1.5 MM ²
DOUBLE CABLE BOW FIRE RETARDANT	SPITKB16F	16 CABLES	3 CORE X 1.5 MM ²



PRYSMIAN FIREFIX CLIPS

Description	Stock Code	Cable Diameter	Colour
FIREFIX SINGLE CLIP 01 SIZE	FFS01	8MM- 8.2 MM	RED
FIREFIX DOUBLE CLIP 04 SIZE	FFD04	8.5 MM - 9 MM	RED



THREADED ROD HANGER

Description	Stock Code
THREADED ROD HANGER M 6 - M8	011430



SPIT SPITFIRE P370 POWDER ACTUATED CARTRIDGE TOOL

Description	Stock Code
SPIT SPITFIRE P370 POWDER ACTUATED CARTRIDGE TOOL	P370



CARTRIDGES TO SUIT SPIT 370

Description	Strength	Stock Code
BROWN CARTRIDGE	VERY LOW	P200B
GREEN CARTRIDGE	LOW	P200G
YELLOW CARTRIDGE	MEDIUM	P200Y
RED CARTRIDGE	HIGH	P200R

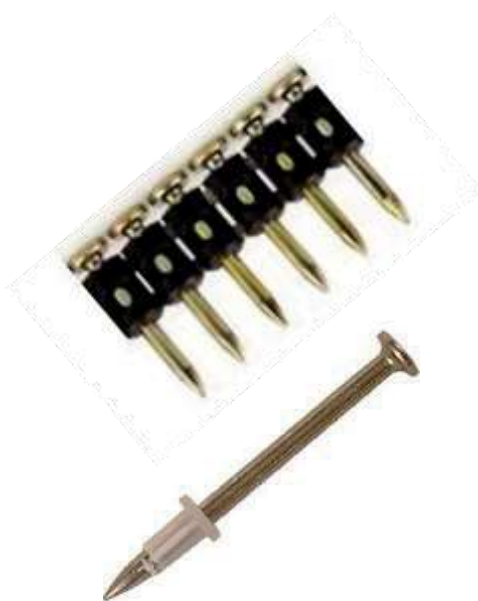

PINS TO SUIT EITHER SINGLE SHOT OR COLLATED FOR USE WITH MAGAZINE

(ADD C AT THE END OF CODE FOR COLLATED)

For Concrete	Length	For Hard Concrete & Steel	Length
C920	20MM	SC915	15MM
C925	25MM	SC920	20MM
C930	30MM	SC925	25MM
C935	35MM	SC930	30MM
C940	40MM	SC935	35MM
C950	50MM	SC940	40MM
C955	55MM	SC950	50MM
C960	60MM	SC960	60MM
C970 SINGLE ONLY	70MM	SC970	70MM
C980 SINGLE ONLY	80MM		
C990 SINGLE ONLY	90MM		

CI 6 INSULATION PINS 65MM DIAMETER HEAD FOR FIXING RIGID INSULATION (ADAPTOR KIT REQUIRED)



Description	Pin Length
CI6 50	50MM
CI6 60	60MM
CI6 70	70MM
CI6 80	80MM
CI6 90	90MM
CI6 100	100MM
CI6 120	120MM

CARTRIDGES TO SUIT HILTI DX 450

Description	Stock Code
Red DX Cartridges	DXC01
Black DX Cartridges	DXC02

DRIVE PINS TO SUIT HILTI DX450

Description	Stock Code
14mm Washered Drive Pins	DXP14
16mm Washered Drive Pins	DXP16
19mm Washered Drive Pins	DXP19
22mm Washered Drive Pins	DXP22
27mm Washered Drive Pins	DXP27
32mm Washered Drive Pins	DXP32
37mm Washered Drive Pins	DXP37
42mm Washered Drive Pins	DXP42
47mm Washered Drive Pins	DXP47
54mm Washered Drive Pins	DXP54
62mm Washered Drive Pins	DXP62
72mm Washered Drive Pins	DXP72
82mm Washered Drive Pins	DXP82
97mm Washered Drive Pins	DXP97

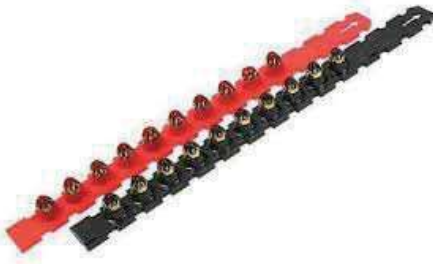



PASLODE IM350 IMPULSE 1ST FIX STRIP NAILER

Description	Stock Code
IM350 / 90 CTQ 1st FIX STRIP NAILER	IM350

NAIL AND FUEL PACKS

Description	Stock Code IM350	Stock Code IM360
51 x 2.8mm Ring Bright	35051B	36051B
51 x 2.8mm Ring Galv Plus	35051G	36051G
63 x 2.8mm Ring Bright	3506328B	36063B
63 x 2.8mm Ring Galv Plus	3506328G	36063G
63 x 3.1mm Ring Galv Plus	3506331G	3606331G
75 x 3.1mm Ring Bright	35075B	36075B
75 x 3.1mm Ring Galv Plus	35075G	36075G
90 x 3.1mm ST Bright	35090B	36090B
90 x 3.1mm ST Galv Plus	35090STG	36090G
63 x 2.8mm Ring St/Steel	35063SSHP	36063SSHP
51 x 2.8mm Ring St/Steel	35051SSHP	36051SSHP
80 x 3.1mm Ring St/Steel	35080SSHP	36080SSHP



IM250/65 2nd FIX BRAD NAILER

Description	Stock Code	Description	Stock Code
F16 x 16mm Galv	6516	F16 x 38mm Galv	6538
F16 x 19mm Galv	6519	F16 x 45mm Galv	6545
F16 x 25mm Galv	6525	F16 x 50mm Galv	6550
F16 x 32mm Galv	6532	F16 x 64mm Galv	6564

18 GAUGE BRADS FOR IM50 / STAPLES FOR IM200

Description	Stock Code	STAPLES FOR IM200 / 50 S16 STAPLER	Stock Code
F18 X 16 MM GALV	5016	16 g X 19 MM STAPLE	GS19
F18 X 25 MM GALV	5025	16 g X 25 MM STAPLE	GS25
F18 X 32 MM GALV	5032	16 g X 35 MM STAPLE	GS35
F18 X 38 MM GALV	5038	16 g X 50 MM STAPLE	GS50
F18 X 50 MM GALV	5050		

PPN 35CI POSITIVE PLACEMENT NAILER

Description	Stock Code
PPN 35CI POSITIVE PLACEMENT NAILER	PPN35
35 MM X 3.4 MM TWISTED GALV NAIL	PPN35SQT

GAS & NAILS TO SUIT PASLODE IM350 AND OTHER SIMILAR GAS NAILERS C/W GAS

Description	Stock Code	Description	Stock Code
51 X 2.8 MM NAIL AND GAS	ELGV51	75 X 3.1 MM NAILS AND GAS	ELGV75
63 X 2.8 MM NAILS AND GAS	ELGV63	90 X 3.1 MM NAILS AND GAS	ELGV90



ULTIMATE SCREW

Description	Stock Code
3.0 x 12 Ultimate Screw	ULT312
3.0 x 20 Ultimate Screw	ULT320
3.0 x 25 Ultimate Screw	ULT325
3.5 x 12 Ultimate Screw	ULT3512
3.5 x 16 Ultimate Screw	ULT3516
3.5 x 20 Ultimate Screw	ULT3520
3.5 x 25 Ultimate Screw	ULT3525
3.5 x 30 Ultimate Screw	ULT3530
4.0 x 20 Ultimate Screw	ULT4020
4.0 x 25 Ultimate Screw	ULT4025
4.0 x 30 Ultimate Screw	ULT4030
4.0 x 40 Ultimate Screw	ULT4040
4.0 x 45 Ultimate Screw	ULT4045
4.0 x 50 Ultimate Screw	ULT4050
4.0 x 60 Ultimate Screw	ULT4060
4.0 x 70 Ultimate Screw	ULT4070
5.0 x 30 Ultimate Screw	ULT5030
5.0 x 40 Ultimate Screw	ULT5040
5.0 x 50 Ultimate Screw	ULT5050
5.0 x 60 Ultimate Screw	ULT5060
5.0 x 70 Ultimate Screw	ULT5070
5.0 x 80 Ultimate Screw	ULT5080
5.0 x 90 Ultimate Screw	ULT5090
5.0 x 100 Ultimate Screw	ULT5100
6.0 x 50 Ultimate Screw	ULT6050
6.0 x 60 Ultimate Screw	ULT6060
6.0 x 70 Ultimate Screw	ULT6070
6.0 x 80 Ultimate Screw	ULT6080
6.0 x 90 Ultimate Screw	ULT6090
6.0 x 100 Ultimate Screw	ULT6100
6.0 X 130 Ultimate Screw	ULT6130
6.0 X 150 Ultimate Screw	ULT6150
6.0 X 180 Ultimate Screw	ULT6180
6.0 X 200 Ultimate Screw	ULT200



CHIPPY SCREWS ZINC AND YELLOW PASSIVATED

Description	Stock Code
3.0 x 12 Chippy Screw	CHIP312
3.0 x 16 Chippy Screw	CHIP316
3.0 x 20 Chippy Screws	CHIP320
3.0 x 25 Chippy Screw	CHIP325
3.5 x 12 Chippy Screw	CHIP3512
3.5 x 16 Chippy Screw	CHIP3516
3.5 x 20 Chippy Screw	CHIP3520
3.5 x 25 Chippy Screw	CHIP3525
3.5 x 30 Chippy Screw	CHIP3530
4.0 x 16 Chippy Screw	CHIP4016
4.0 x 20 Chippy Screw	CHIP4020
4.0 x 25 Chippy Screw	CHIP4025
4.0 x 30 Chippy Screw	CHIP4030
4.0 x 35 Chippy Screw	CHIP4035
4.0 x 40 Chippy Screw	CHIP4040
4.0 x 45 Chippy Screw	CHIP4045
4.0 x 50 Chippy Screw	CHIP4050
4.0 x 60 Chippy Screw	CHIP4060
4.0 x 70 Chippy Screw	CHIP4070
4.5 x 25 Chippy Screw	CHIP4525
4.5 x 30 Chippy Screw	CHIP4530
4.5 x 35 Chippy Screw	CHIP4535
4.5 x 40 Chippy Screw	CHIP4540
4.5 x 45 Chippy Screw	CHIP4545
4.5 x 50 Chippy Screw	CHIP4550
4.5 x 60 Chippy Screw	CHIP4560
4.5 x 70 Chippy Screw	CHIP4570
4.5 x 75 Chippy Screw	CHIP4575
5.0 x 25 Chippy Screw	CHIP5025
5.0 x 30 Chippy Screw	CHIP5030
5.0 x 35 Chippy Screw	CHIP5035
5.0 x 40 Chippy Screw	CHIP5040
5.0 x 45 Chippy Screw	CHIP5045
5.0 x 50 Chippy Screw	CHIP5050
5.0 x 60 Chippy Screw	CHIP5060
5.0 x 70 Chippy Screw	CHIP5070
5.0 x 75 Chippy Screw	CHIP5075
5.0 x 80 Chippy Screw	CHIP5080
5.0 x 90 Chippy Screw	CHIP5090
5.0 x 100 Chippy Screw	CHIP50100
6.0 x 40 Chippy Screw	CHIP640
6.0 x 50 Chippy Screw	CHIP6050
6.0 x 60 Chippy Screw	CHIP6060
6.0 x 70 Chippy Screw	CHIP6070
6.0 x 80 Chippy Screw	CHIP6080
6.0 x 90 Chippy Screw	CHIP6090
6.0 x 100 Chippy Screw	CHIP60100
6.0 x 110 Chippy Screw	CHIP60110
6.0 x 130 Chippy Screw	CHIP60130
6.0 x 150 Chippy Screw	CHIP60150



WOODSCREWS HARDENED STEEL COUNTERSUNK

Description	Stock Code
4 x 3/8 Supertwin Screws	SUP438
4 x 1/2 Supertwin Screws	SUP412
4 x 5/8 Supertwin Screws	SUP458
4 x 3/4 Supertwin Screws	SUP434
4 x 1 Supertwin Screws	SUP412
6 x 1/2 Supertwin Screws	SUP612
6 x 5/8 Supertwin Screws	SUP658
6 x 3/4 Supertwin Screws	SUP634
6 x 1 Supertwin Screws	SUP61
6 x 1 1/4 Supertwin Screws	SUP6114
6 x 1 1/2 Supertwin Screws	SUP6112
6 x 1 3/4 Supertwin Screws	SUP6134
6 x 2 Supertwin Screws	SUP62
7 x 1/2 Supertwin Screws	SUP712
7 x 5/8 Supertwin Screws	SUP758
7 x 3/4 Supertwin Screws	SUP734
7 x 1 Supertwin Screws	SUP71
7 x 1 1/4 Supertwin Screws	SUP7114
7 x 1 1/2 Supertwin Screws	SUP7112
8 x 1/2 Supertwin Screws	SUP812
8 x 5/8 Supertwin Screws	SUP858
8 x 3/4 Supertwin Screws	SUP834
8 x 1 Supertwin Screws	SUP81
8 x 1 1/4 Supertwin Screws	SUP8114
8 x 1 1/2 Supertwin Screws	SUP8112
8 x 1 3/4 Supertwin Screws	SUP8134
8 x 2 Supertwin Screws	SUP82
8 x 2 1/4 Supertwin Screws	SUP8214
8 x 2 1/2 Supertwin Screws	SUP8212
8 x 3 Supertwin Screws	SUP83
10 x 3/4 Supertwin Screws	SUP1034
10 x 1 Supertwin Screws	SUP101
10 x 1 1/4 Supertwin Screws	SUP10114
10 x 1 1/2 Supertwin Screws	SUP10112
10 x 1 3/4 Supertwin Screws	SUP10134
10 x 2 Supertwin Screws	SUP102
10 x 2 1/4 Supertwin Screws	SUP10214
10 x 2 1/2 Supertwin Screws	SUP10212
10 x 3 Supertwin Screws	SUP103
10 x 3 1/2 Supertwin Screws	SUP312
10 x 4 Supertwin Screws	SUP104
12 x 1 Supertwin Screws	SUP121
12 x 1 1/4 Supertwin Screws	SUP12114
12 x 1 1/2 Supertwin Screws	SUP12112
12 x 2 Supertwin Screws	SUP122
12 x 2 1/4 Supertwin Screws	SUP12214
12 x 2 1/2 Supertwin Screws	SUP12212
12 x 3 Supertwin Screws	SUP123
12 x 3 1/2 Supertwin Screws	SUP12312
12 x 4 Supertwin Screws	SUP124



ROUNDHEAD POZI WOODSCREWS



Description	Stock Code
4 x 1/2 Bzp Roundhead Screws	RH412
6 x 1/2 Bzp Roundhead Screws	RH612
6 x 5/8 Bzp Roundhead Screws	RH658
6 x 3/4 Bzp Roundhead Screws	RH634
6 x 1 Bzp Roundhead Screws	RH612
6 x 1 1/4 Bzp Roundhead Screws	RH6114
6 x 1 1/2 Bzp Roundhead Screws	RH6112
8 x 1/2 Bzp Roundhead Screws	RH812
8 x 5/8 Bzp Roundhead Screws	RH858
8 x 3/4 Bzp Roundhead Screws	RH834
8 x 1 Bzp Roundhead Screws	RH81
8 x 1 1/4 Bzp Roundhead Screws	RH8114
8 x 1 1/2 Bzp Roundhead Screws	RH8112
8 x 2 Bzp Roundhead Screws	RH82
10 x 1 BZP Roundhead Screws	RH101
10 x 1 1/4 Bzp Roundhead Screws	RH10114
10 x 1 1/2 Bzp Roundhead Screws	RH10112
10 x 2 Bzp Roundhead Screws	RH102
10 x 2 1/2 Bzp Roundhead Screws	RH10212
10 x 3 Bzp Roundhead Screws	RH103

BRASS COUNTERSUNK WOODSCREWS

Description	Stock Code
4 x 3/8 Brass Csk Screws	BC438
4 x 1/2 Brass Csk Screws	BCS412
4 x 5/8 Brass Csk Screws	BCS58
4 x 3/4 Brass Csk Screws	BCS434
4 x 1 Brass Csk Screws	BCS412
6 x 1/2 Brass Csk Screws	BCS612
6 x 5/8 Brass Csk Screws	BCS658
6 x 3/4 Brass Csk Screws	BCS634
6 x 1 Brass Csk Screws	BCS61
6 x 1 1/4 Brass Csk Screws	BCS114
6 x 1 1/2 Brass Csk Screws	BCS112
7 x 3/4 Brass Csk Screws	BCS734
7 x 1 Brass Csk Screws	BCS71
7 x 1 1/4 Brass Csk Screws	BCS7114
8 x 1/2 Brass Csk Screws	BCS812
8 x 5/8 Brass Csk Screws	DCS858
8 x 3/4 Brass Csk Screws	BCS834
8 x 1 Brass Csk Screws	BCS81
8 x 1 1/4 Brass Csk Screws	BCS8114
8 x 1 1/2 Brass Csk Screws	BCS8112
8 x 1 3/4 Brass Csk Screws	BCS8134
8 x 2 Brass Csk Screws	BCS82
8 x 2 1/2 Brass Csk Screws	BCS212
10 x 1 Brass Csk Screws	BCS101
10 x 1 1/4 Brass Csk Screws	BCS10114
10 x 1 1/2 Brass Csk Screws	BCS10112
10 x 1 3/4 Brass Csk Screws	BCS134
10 x 2 Brass Csk Screws	BCS102
10 x 2 1/2 Brass Csk Screws	BCS10212
10 x 3 Brass Csk Screws	BCS103
12 x 1 1/4 Brass Csk Screws	BCS114
12 x 1 1/2 Brass Csk Screws	BCS112
12 x 2 Brass Csk Screws	BCS122
12 x 2 1/2 Brass Csk Screws	BCS12212
12 x 3 Brass Csk Screws	BCS123
12 x 4 Brass Csk Screws	BCS124

BRASS ROUNDHEAD WOODSCREWS

Description	Stock Code
6 x 1/2 Roundhead Brass Screws	BRH612
6 x 5/8 Roundhead Brass Screws	BRH658
6 x 3/4 Roundhead Brass Screws	BRH634
6 x 1 Roundhead Brass Screws	BRH612
6 x 1 1/4 Roundhead Brass Screws	BRH6114
6 x 1 1/2 Roundhead Brass Screws	BRH6112
8 x 1/2 Roundhead Brass Screws	BRH812
8 x 3/4 Roundhead Brass Screws	BRH834
8 x 1 Roundhead Brass Screws	BRH812
8 x 1 1/4 Roundhead Brass Screws	BRH8114
8 x 1 1/2 Roundhead Brass Screws	BRH8112
8 x 2 Roundhead Brass Screws	BRH82
10 x 1 Roundhead Brass Screws	BRH101
10 x 1 1/4 Roundhead Brass Screws	BRH10114
10 x 1 1/2 Roundhead Brass Screws	BRH10112
10 x 2 Roundhead Brass Screws	BRH102



CHIPBOARD S/S COUNTERSUNK WOODSCREWS

Description	Stock Code
4.0 x 20 St/St Csk Screws	CHIP420SS
4.0 x 25 St/St Csk Screws	CHIP425SS
4.0 x 30 St/St Csk Screws	CHIP430SS
4.0 x 35 St/St Csk Screws	CHIP435SS
4.0 x 40 St/St Csk Screws	CHIP440SS
4.0 x 50 St/St Csk Screws	CHIP450SS
4.0 x 60 St/St Csk Screws	CHIP460SS
4.0 x 70 St/St Csk Screws	CHIP470SS
5.0 x 30 St/St Csk Screws	CHIP530SS
5.0 x 40 St/St Csk Screws	CHIP540SS
5.0 x 50 St/St Csk Screws	CHIP550SS
5.0 x 60 St/St Csk Screws	CHIP560SS
5.0 x 70 St/St Csk Screws	CHIP570SS
5.0 x 80 St/St Csk Screws	CHIP580SS
5.0 x 90 St/St Csk Screws	CHIP590SS
5.0 x 100 St/St Csk Screws	CHIP5100SS
6.0 x 30 St/St Csk Screws	CHIP630SS
6.0 x 40 St/St Csk Screws	CHIP640SS
6.0 x 50 St/St Csk Screws	CHIP650SS
6.0 x 60 St/St Csk Screws	CHIP660SS
6.0 x 70 St/St Csk Screws	CHIP670SS
6.0 x 80 St/St Csk Screws	CHIP680SS
6.0 x 90 St/St Csk Screws	CHIP690SS
6.0 x 100 St/St Csk Screws	CHIP6100SS



ROUNDHEAD STAINLESS STEEL WOODSCREWS

Description	Stock Code
8 x 3/4 St/St Roundhead Screws	RH834SS
8 x 1 1/4 St/St Roundhead Screws	RH8114SS
8 x 1 1/2 St/St Roundhead Screws	RH8112SS
8 x 2 St/St Roundhead Screws	RH82SS
10 x 1 St/St Roundhead Screws	RH101SS
10 x 1 1/4 St/St Roundhead Screws	RH10114SS
10 x 1 1/2 St/St Roundhead Screws	RH10112SS
10 x 2 St/St Roundhead Screws	RH102SS
10 x 2 1/2 St/St Roundhead Screws	RH10212SS
10 x 3 St/St Roundhead Screws	RH103SS
12 x 1 1/2 St/St Roundhead Screws	RH12112SS
12 x 2 St/St Roundhead Screws	RH122SS
12 x 2 1/2 St/St Roundhead Screws	RH12212SS
12 x 3 St/St Roundhead Screws	RH123SS



SELF TAPPING SCREWS ZINC PLATED

Description	Stock Code
1/4 x 6 Bzp Self Tapping Screw	STS614
3/8 x 6 Bzp Self Tapping Screw	STS638
1/2 x 6 Bzp Self Tapping Screw	STS612
5/8 x 6 Bzp Self Tapping Screw	STS658
3/4 x 6 Bzp Self Tapping Screw	STS634
1 x 6 Bzp Self Tapping Screw	STS61
1 1/4 x 6 Bzp Self Tapping Screw	STS6114
1 1/2 x 6 Bzp Self Tapping Screw	STS6112
3/8 x 8 Bzp Self Tapping Screw	STS838
1/2 x 8 Bzp Self Tapping Screw	STS81
5/8 x 8 Bzp Self Tapping Screw	STS858
3/4 x 8 Bzp Self Tapping Screw	STS834
1 x 8 Bzp Self Tapping Screw	STS812
1 1/4 x 8 Bzp Self Tapping Screw	STS8114
1 1/2 x 8 Bzp Self Tapping Screw	ST8112
2 x 8 Bzp Self Tapping Screw	STS82
3/8 x 10 Bzp Self Tapping Screw	STS1038
1/2 x 10 Bzp Self Tapping Screw	STS1012
5/8 x 10 Bzp Self Tapping Screw	STS1058
3/4 x 10 Bzp Self Tapping Screw	STS1034
1 x 10 Bzp Self Tapping Screw	STS101
1 1/4 x 10 Bzp Self Tapping Screw	STS10114
1 1/2 X 10 Bzp Self Tapping Screw	STS10112
2 x 10 Bzp Self Tapping Screw	STS102
3/4 x 12 Bzp Self Tapping Screw	STS1234
1 1/4 x 12 Bzp Self Tapping Screw	STS12114
1 1/2 x 12 Bzp Self Tapping Screw	STS12112
1 3/4 x 12 Bzp Self Tapping Screw	STS12134
2 x 12 Bzp Self Tapping Screw	STS122
1/2 x 14 Bzp Self Tapping Screw	STS1412
5/8 x 14 Bzp Self Tapping Screw	STS1458
3/4 x 14 Bzp Self Tapping Screw	STS1434
1 x 14 Bzp Self Tapping Screw	STS141
1 1/4 x 14 Bzp Self Tapping Screw	STS14114
1 1/2 x 14 Bzp Self Tapping Screw	STS14112
1 3/4 x 14 Bzp Self Tapping Screw	STS14134
2 x 14 Bzp Self Tapping Screw	STS142

HEX HEAD SELF TAPPING SCREWS

Description	Stock Code
6.3 X 19 MM BZP HEX HEAD SELF TAPPING SCREW	STS6319H
6.3 X 25 MM BZP HEX HEAD SELF TAPPING SCREW	STS6325H
6.3 X 32 MM BZP HEX HEAD SELF TAPPING SCREW	STS6332H
6.3 X 38 MM BZP HEX HEAD SELF TAPPING SCREW	STS6338H
6.3 X 50 MM BZP HEX HEAD SELF TAPPING SCREW	STS6350H



BRASS SURFACE AND TURNED SCREW CAPS

Description	Stock Code
6 Brass Surface Screw Cup	SSCB6
7-8 Brass Surface Screw Cup	SSCB78
9-10 Brass Surface Screw Cup	SSCB910
11-12 Brass Surface Screw Cup	SSCB1112



PLASTIC DOME CAPS WITH WASHERS

Description	Stock Code
White Dome Cap & Washer	DCW
Black Dome Cap & Washer	DCBL
Light Brown Dome Cap & Washer	DCLB
Dark Brown Dome Cap & Washer	DCDB
Chrome Dome Cap & Washer	DCCH



PLUS TOP PLASTIC CAP NO.2

Description	Stock Code
Black Plus Top No.2	PLUSBL
White Plus Top No.2	PLUSW
Light Brown Plus Top No.2	PLUSLB
Dark Brown Plus Top No.2	PLUSDB



PATENT SCREW TIES

Description	Stock Code
Screw Ties Zinc Plated	PST01



TABLE STRETCHER PLATES

Description	Stock Code
1 1/2 Table Stretcher Plates	TSP



STAPLES & STAPLE GUNS

Description	Stock Code
Heavy Duty Staple Gun	T50G
Heavy Duty Hammer Tacker	HT50A
6mm Staples	STP06
8mm Staples	STP08
10mm Staples	STP10
12mm Staples	STP12
14mm Staples	STP14

SCREWDRIVER BITS AND ADAPTORS



DESCRIPTION	LENGTH	LENGTH	LENGTH
NO 1 POZ1 BITS	25 MM	50 MM	
NO 2 POZ1 BITS	25 MM	50 MM	150 MM
NO 3 POZ1 BITS	25 MM	50 MM	
NO 4 POZ1 BITS	25 MM	50 MM	
NO 1 PHILLIPS BITS	25 MM	50 MM	
NO 2 PHILIPS BITS	25 MM	50 MM	150 MM
NO 3 PHILLIPS BITS	25 MM	50 MM	
NO 4 PHILLIPS BITS	25 MM	50MM	
TORX 10 BITS 25 MM	25 MM	25 MM	
TORX 15 BITS 25 MM	25 MM	25 MM	
TORX 20 BITS 25 MM	25 MM	25 MM	
TORX 25 BITS 25 MM	25 MM	25 MM	
TORX 30 BITS 25 MM	25 MM	25 MM	
TORX 40 BITS 25 MM	25 MM	25 MM	
TORX 50 BITS 25 MM	25 MM	25 MM	



SCREWDRIVER BIT HOLDER

SDS SCREWDRIVER BIT HOLDER

SDBHSDS

ZINC FINE THREAD LOOSE DRYWALL SCREWS FOR METAL STUD UP TO 1 MM THICK



Description	Stock Code	Stock Code
	ZINC	BLACK
25mm Drywall Screws	DW25	DW25B
32mm Drywall Screws	DW32	DW32B
38mm Drywall Screws	DW38	DW38B
42mm Drywall Screws	DW42	DW42B
50mm Drywall Screws	DW50	DW50B
60mm Drywall Screws	DW60	DW60B
65mm Drywall Screws	DW65	DW65B
75mm Drywall Screws	DW75	DW75B
100mm Drywall Screws	DW100	
125mm Drywall Screws	DW125	
150mm Drywall Screws	DW150	

COARSE THREAD LOOSE DRYWALL SCREWS FOR TIMBER STUDS



Description	Stock Code	Description	Stock Code
25mm Drywall Screws	DWC25	65mm Drywall Screws	DWC65
32mm Drywall Screws	DWC32	75mm Drywall Screws	DWC75
38mm Drywall Screws	DWC38	100mm Drywall Screws	DWC100
42mm Drywall Screws	DWC42	125mm Drywall Screws	DWC125
50mm Drywall Screws	DWC50	150mm Drywall Screws	DWC150

SELF DRILL SCREWS FOR LIGHT GAUGE STEEL UP TO 2.5 MM TRACK



Description	Stock Code
3.5 x 25 Bugle Head Self Drill	DWSD050
3.5 x 32 Bugle Head Self Drill	DWSD052
3.5 x 38 Bugle Head Self Drill	DWSD054
3.5 x 42 Bugle Head Self Drill	DWSD056
3.5 x 50 Bugle Head Self Drill	DWSD058
3.5 x 60 Bugle Head Self Drill	DWSD060
4.2 x 75 Bugle Head Self Drill	DWSD075
4.8 X 100 Bugle Head Self Drill	DWSD100
4.8 x 125 Bugle Head Self Drill	DWSD125

WAFER HEAD SELF DRILLING SCREW



Description	Stock Code
4.2 X 12 WAFER SELF DRILL BZP	WSD4213
4.2 X 19 WAFER SELF DRILL BZP	WSD4219
4.2 X 25 WAFER SELF DRILL BZP	WSD4225
4.2 X 50 WAFER SELF DRILL BZP	WSD4250
4.2 X 13 WAFER NON DRILL BZP	WND4213

COLLATED DRYWALL SCREWS ZINC PLATED FINE THREAD



Description	Stock Code
25mm Collated Drywall	CDWS25
32mm Collated Drywall	CDWS32
35mm Collated Drywall	CDW35
38mm Collated Drywall	CDWS38
42mm Collated Drywall	CDWS42
45mm Collated Drywall	CDWS45
50mm Collated Drywall	CDWS50
55mm Collated Drywall	CDWS55
75mm Collated Drywall	CDWS75

COLLATED DRYWALL SCREWS COARSE THREAD



Description	Stock Code
25mm Collated Drywall	CDWS25C
32mm Collated Drywall	CDWS32C
35mm Collated Drywall	CDWS35C
38mm Collated Drywall	CDWS38C
42mm Collated Drywall	CDWS42C
45mm Collated Drywall	CDWS45C
50mm Collated Drywall	CDWS50C
55mm Collated Drywall	CDWS55C
65mm Collated Drywall	CDWS65C
75mm Collated Drywall	CDWS75C

COLLATED SELF DRILLING DRYWALL SCREWS



Description	Stock Code
3.5 X 25 SELF DRILLING DRYWALL SCREW	CDWSD25
3.5 X 35 SELF DRILLING DRYWALL SCREW	CDWSD35
3.5 X 45 SELF DRILLING DRYWALL SCREW	CDWSD45
3.5 X 50 SELF DRILLING DRYWALL SCREW	CDWS50



TOUGH BOARD SCREWS FOR HARD SURFACED BOARDS TO METAL TRACK AND TIMBER

Description	Stock Code
F35 3.9 X 35 MM TOUGH BOARD SCREW	TBS35
F35 3.9 X 35 MM TOUGH BOARD SCREW	TBS45

CEMENTITIOUS BOARD SCREWS

Description	Stock Code
4.2 X 32 MM CEMENTITIOUS BOARD SCREW (HI / LO)	CBS32
4.2 X 42 MM CEMENTITIOUS BOARD SCREW (HI / LO)	CBS42
4.2 X 32 MM CEMENTITIOUS BOARD SCREW (HI / LO)	CBSD32
4.2 X 42 MM CEMENTITIOUS BOARD SCREW (HI / LO)	CBSD42

REVERSE THREAD DRYWALL SCREWS FOR FIXING DENSE PLASTERBOARD TO DRYWALL TRACK AND TIMBER

Description	Stock Code
3.9 X 32 MM REVERSE THREAD DRYWALL SCREW	DWRT32
3.9 X 42 MM REVERSE THREAD DRYWALL SCREW	DWRT42

PANCAKE HEAD METAL FRAMING SCREWS FOR 1.2 - 3.5 MM STEEL

Description	Stock Code
4.8 X 16 MM PANCAKE SELF DRILL	TSPH16
4.8 X 19 MM PANCAKE SELF DRILL	TSPH19
4.8 X 25 MM PANCAKE SELF DRILL	TSPH25

ACOUSTIC HANGERS

Description	Stock Code
ACOUSTIC HANGERS	EVAB1

CEILING BRACKETS

Description	Stock Code
CEILING BRACKETS	CB

HEX HEAD LIGHT SECTION SELF DRILLING SCREW FOR 1.2 - 3.5 MM STEEL

Description Also available in Bi Metal stainless steel	Stock Code EVOSHIELD COAT	Stock Code STAINLESS STEEL
4.8 X 16 MM HEX TEK SCREW	TC16	
5.5 X 19 MM HEX TEK SCREW	TC19	
5.5 X 25 MM HEX TEK SCREW	TC25	TC25SS
5.5 X 32 MM HEX TEK SCREW	TC32	
5.5 X 38 MM HEX TEK SCREW	TC38	TC38SS
5.5 X 50 MM HEX TEK SCREW	TC50	TC50SS
5.5 X 75 MM HEX TEK SCREW	TC75	TC80SS
5.5 X 100MM HEX TEK SCREW	TC100	TC100SS

HEX HEAD HEAVY SECTION SELF DRILLING SCREW FOR 4 - 12.5 MM STEEL

Description Also available in Bi Metal stainless steel	Stock Code EVOSHIELD COAT	Stock Code STAINLESS STEEL
5.5 X 32 MM HEX HEAD TEK SCREW	TL32	
5.5 X 38 MM HEX HEAD TEK SCREW	TL38	TL38SS
5.5 X 50 MM HEX HEAD TEK SCREW	TL50	TL50SS
5.5 X 75 MM HEX HEAD TEK SCREW	TL75	
5.5 X 100 MM HEX HEAD TEK SCREW	TL100	

HEX HEAD LIGHT SECTION SELF DRILLING SCREW FOR 1.2 - 3.5 MM STEEL WITH BONDED WASHER

Description Also available in Bi Metal stainless steel	Stock Code EVOSHIELD COAT	Stock Code STAINLESS STEEL
5.5 X 25 MM HEX TEK SCREW	MXC26	MXC26SS
5.5 X 32 MM HEX TEK SCREW	MXC32	
5.5 X 38 MM HEX TEK SCREW	MXC38	MXC38SS
5.5 X 50 MM HEX TEK SCREW	MXC50	MXC50SS
5.5 X 75 MM HEX TEK SCREW	MXC75	
5.5 X 100MM HEX TEK SCREW	MXC100	
5.5 X 135 MM HEX TEK SCREW	MXC135SS	

HEX HEAD HEAVY SECTION SELF DRILLING SCREW FOR 4 - 12.5 MM STEEL WITH BONDED WASHER

Description Also available in Bi Metal stainless steel	Stock Code EVOSHIELD COAT	Stock Code STAINLESS STEEL
5.5 X 38 MM HEX HEAD TEK SCREW	MXL38	MXL38SS
5.5 X 50 MM HEX HEAD TEK SCREW	MXL50	MXL50SS
5.5 X 75 MM HEX HEAD TEK SCREW	MXL75	
5.5 X 100 MM HEX HEAD TEK SCREW	MXL100	MXL100SS

HEX HEAD SUPERTEK SELF DRILLING SCREWS FOR 4 - 18 MM STEEL

Description	Stock Code
5.5 X 50 MM SUPERTEK	SUPERTEK50
5.5 X 50 MM SUPERTEK WITH BONDED WASHER	SUPERTEK50W
6.3 X 60 MM SUPERTEK	SUPERTEK60



COUNTERSUNK HEAD SUPERTEK SELF DRILLING SCREWS FOR 4 - 18 MM STEEL

Description	Stock Code
5.5 X 73 COUNTERSUNK SUPERWING TEK SCREW	SUPERWING73
5.5 X 80 COUNTERSUNK SUPERWING TEK SCREW	SUPERWING80
5.5 X 93 COUNTERSUNK SUPERWING TEK SCREW	SUPERWING93



COUNTERSUNK TIMBERFIX WINGED TEK SCREWS FOR LIGHT SECTION 1.2 - 3.5 MM STEEL

Description Also available in Bi Metal stainless steel	Stock Code EVOSHIELD COAT	Stock Code STAINLESS STEEL
4.2 X 38 MM COUNTERSUNK TEK SCREW	TFC38	TFC38SS
4.8 X 45 MM COUNTERSUNK TEK SCREW	TFC45	
5.5 X 50 MM COUNTERSUNK TEK SCREW	TFC50	
5.5 X 62 MM COUNTERSUNK TEK SCREW	TFC62	TFC62SS
5.5 X 80 MM COUNTERSUNK TEK SCREW	TFC80	TFC80SS
5.5 X 100 MM COUNTERSUNK TEK SCREW	TFC100	
5.5 X 120 MM COUNTERSUNK TEK SCREW	TFC120	
5.5 X 150 MM COUNTERSUNK TEK SCREW	TFC150	
5.5 X 180 MM COUNTERSUNK TEK SCREW	TFC180	



COUNTERSUNK TIMBERFIX WINGED TEK SCREWS FOR HEAVY SECTION 4 - 12.5 MM STEEL

Description Also available in Bi Metal stainless steel	Stock Code EVOSHIELD COAT	Stock Code STAINLESS STEEL
5.5 X 42 MM COUNTERSUNK TEK SCREW	TFL42	
5.5 X 65 MM COUNTERSUNK TEK SCREW	TFL65	TFL65SS
5.5 X 85 MM COUNTERSUNK TEK SCREW	TFL85	TFL85SS
5.5 X 100 MM COUNTERSUNK TEK SCREW	TFL100	
5.5 X 110 MM COUNTERSUNK TEK SCREW	TFL110	
5.5 X 135 MM COUNTERSUNK TEK SCREW	TFL135	TFL135SS
5.5 X 150 MM COUNTERSUNK TEK SCREW	TFL150	
5.5 X 180 MM COUNTERSUNK TEK SCREW	TFL180	



GASH POINT AND STICHING SCREWS HEX HEAD

Description	Stock Code
32mm Gash Point Hex Tek screws	GASH32
45mm Gash Point Hex Tek Screws	GASH45
60mm Gash Point Hex Tek Screws	GASH60
80mm Gash Point Hex Tek Screws	GASH80
6.3 X 22 Stitching Screw	TS22
G16 Bonded Washer	G16
G19 BONDED WASHER	G19
COVER CAPS	

INDEX SCREWS

HEX HEAD TIMBER SCREWS WITH 8MM A/F DRIVE ALSO AVAILABLE IN STAINLESS STEEL AND WAFER HEA

Description	Stock Code
6.3 x 75mm Index Screw	Index75
6.3 x 100mm Index Screw	Index100
6.3 x 125mm Index Screw	Index125
6.3 x 150mm Index Screw	Index150
6.3 x 200mm Index Screw	Index200
6.3 x 250mm Index Screw	Index250

PACKING SHIMS

101 X 43 MM BOXED IN 500 s OR BAGS OF 200

Size	Stock Code
1 MM	PS1100
2 MM	PS2100
3 MM	PS3100
4 MM	PS4100
5 MM	PS5100
6 MM	PS6100
10 MM (BOXED 250)	PS10100
MIXED SHIMS (BAG 200)	PSMIX

HEX HEAD COACH SCREW ZINC PLATED



Description	Stock Code
M6 x 20 Bzp Hex Coach Screw	COACH620
M6 x 25 Bzp Hex Coach Screw	COACH625
M6 x 30 Bzp Hex Coach Screw	COACH630
M6 x 35 Bzp Hex Coach Screw	COACH635
M6 x 40 Bzp Hex Coach Screw	COACH640
M6 x 50 Bzp Hex Coach Screw	COACH650
M6 x 60 Bzp Hex Coach Screw	COACH660
M6 x 65 Bzp Hex Coach Screw	COACH665
M6 x 70 Bzp Hex Coach Screw	COACH670
M6 x 75 Bzp Hex Coach Screw	COACH675
M6 x 80 Bzp Hex Coach Screw	COACH680
M6 x 90 Bzp Hex Coach Screw	COACH690
M6 x 100 Bzp Hex Coach Screw	COACH6100
M8 x 25 Bzp Hex Coach Screw	COACH825
M8 x 30 Bzp Hex Coach Screw	COACH830
M8 x 40 Bzp Hex Coach Screw	COACH840
M8 x 50 Bzp Hex Coach Screw	COACH850
M8 x 60 Bzp Hex Coach Screw	COACH860
M8 X 65 Bzp Hex Coach Screw	COACH865
M8 x 70 Bzp Hex Coach Screw	COACH870
M8 x 75 Bzp Hex Coach Screw	COACH875
M8 x 80 Bzp Hex Coach Screw	COACH880
M8 x 90 Bzp Hex Coach Screw	COACH890
M8 x 100 Bzp Hex Coach Screw	COACH8100
M8 x 110 Bzp Hex Coach Screw	COACH8110
M8 x 120 Bzp Hex Coach Screw	COACH8120
M8 x 150 Bzp Hex Coach Screw	COACH8150
M10 x 25 Bzp Hex Coach Screw	COACH1025
M10 x 30 Bzp Hex Coach Screw	COACH1030
M10 x 40 Bzp Hex Coach Screw	COACH1040
M10 x 50 Bzp Hex Coach Screw	COACH1050
M10 x 60 Bzp Hex Coach Screw	COACH1060
M10 x 65 Bzp Hex Coach Screw	COACH1065
M10 x 70 Bzp Hex Coach Screw	COACH1070
M10 x 75 Bzp Hex Coach Screw	COACH1075
M10 x 80 Bzp Hex Coach Screw	COACH1080
M10 x 90 Bzp Hex Coach Screw	COACH1090
M10 x 100 Bzp Hex Coach Screw	COACH10100
M10 x 110 Bzp Hex Coach Screw	COACH10110
M10 x 120 Bzp Hex Coach Screw	COACH10120
M10 x 130 Bzp Hex Coach Screw	COACH10130
M10 x 140 Bzp Hex Coach Screw	COACH10140
M10 x 150 Bzp Hex Coach Screw	COACH10150
M10 x 160 Bzp Hex Coach Screw	COACH10160
M10 x 180 Bzp Hex Coach Screw	COACH10180
M10 x 200 Bzp Hex Coach Screw	COACH10200
M12 x 40 Bzp Hex Coach Screw	COACH1240
M12 x 50 Bzp Hex Coach Screw	COACH1250
M12 x 60 Bzp Hex Coach Screw	COACH1260
M12 x 65 Bzp Hex Coach Screw	COACH1265
M12 x 70 Bzp Hex Coach Screw	COACH1270
M12 x 80 Bzp Hex Coach Screw	COACH1280
M12 x 90 Bzp Hex Coach Screw	COACH1290
M12 x 100 Bzp Hex Coach Screw	COACH12100
M12 x 110 Bzp Hex Coach Screw	COACH12110
M12 x 120 Bzp Hex Coach Screw	COACH12120
M12 x 130 Bzp Hex Coach Screw	COACH12130
M12 x 140 Bzp Hex Coach Screw	COACH12140
M12 x 150 Bzp Hex Coach Screw	COACH12150
M12 x 160 Bzp Hex Coach Screw	COACH12160
M12 x 180 Bzp Hex Coach Screw	COACH12180
M12 x 200 Bzp Hex Coach Screw	COACH12200

CUP SQUARE CARRAIGE BOLTS ZINC PLATED



Description	Stock Code (M6)	Stock Code (M8)
25mm	Cup625	Cup825
40mm	Cup640	Cup840
50mm	Cup650	Cup850
60mm	Cup660	Cup860
75mm	Cup675	Cup875
100mm	Cup6100	Cup8100
130mm		Cup8130



Description	Stock Code (M10)	Stock Code (M12)
25mm	Cup1025	
30mm	Cup1030	Cup1230
40mm	Cup1040	Cup1240
50mm	Cup1050	Cup1250
60mm	Cup1060	Cup1260
65mm	Cup1065	
75mm	Cup1075	Cup1275
100mm	Cup10100	Cup12100
110mm	Cup10110	Cup12110
120mm	Cup10120	Cup12120
130mm	Cup10130	Cup12130
160mm	Cup10160	Cup12150
180mm	Cup10180	Cup12160
200mm	Cup10200	Cup12180
220mm	Cup10220	Cup12200
250mm	Cup10250	Cup12220
260mm	Cup10260	Cup12250
280mm	Cup10280	Cup12280
300mm	Cup10300	Cup12300

HEX HEAD SET SCREW ZINC PLATED



Description	Bzp Code	St Code
	BRIGHT ZINC PLATED	STAINLESS STEEL
M6 x 12 Set Screw	SET612	SET612SS
M6 x 16 Set Screw	SET616	SET616SS
M6 x 20 Set Screw	SET620	SET620SS
M6 x 25 Set Screw	SET625	SET625SS
M6 x 30 Set Screw	SET630	SET630SS
M6 x 40 Set Screw	SET640	SET640SS
M6 x 50 Set Screw	SET650	SET650SS
M6 x 60 Set Screw	SET660	SET660SS
M6 x 80 Set Screw	SET680	SET680SS
M8 x 16 Set Screw	SET816	SET816SS
M8 x 20 Set Screw	SET820	SET820SS
M8 x 25 Screw	SET825	SET825SS
M8 x 30 Screw	SET830	SET830SS
M8 x 40 Screw	SET840	SET840SS
M8 x 50 Screw	SET850	SET850SS
M8 x 60 Screw	SET860	SET860SS
M8 x 80 Screw	SET880	SET880SS
M8 x 100 Screw	SET8100	SET8100SS
M10 x 20 Set Screw	SET1020	SET1020SS
M10 x 25 Set Screw	SET1025	SET1025SS
M10 x 30 Set Screw	SET1030	SET1030SS
M10 x 40 Set Screw	SET1040	SET1040SS
M10 x 50 Set Screw	SET1050	SET1050SS
M10 x 60 set Screw	SET1060	SET1060SS
M10 x 80 Set Screw	SET1080	SET1080SS
M10 x 100 Set Screw	SET10100	SET10100SS
M12 x 20 Set Screw	SET1220	SET1220SS
M12 x 25 Set Screw	SET1225	SET1225SS
M12 x 30 Set Screw	SET1230	SET1230SS
M12 x 40 Set Screw	SET1240	SET1240SS
M12 x 50 Set Screw	SET1250	SET1250SS
M12 x 60 Set Screw	set1260	SET1260SS
M12 x 80 Set Screw	SET1280	SET1280SS
M12 x 100 Set Screw	SET12100	SET12100
M16 x 25 Set Screw	SET1625	SET1625SS
M16 x 30 Set Screw	SET1630	SET1630SS
M16 x 40 Set Screw	SET1640	SET1640SS
M16 x 50 Set Screw	SET1650	SET1650SS
M16 x 60 Set Screw	SET1660	SET1660SS
M16 x 65 Set Screw	SET1665	SET1665SS
M16 x 70 Set Screw	SET1670	SET1670SS
M16 x 80 Set Screw	SET1680	SET1680SS
M16 x 100 Set Screw	SET16100	SET16100SS

8.8 HIGH TENSILE BOLTS BZP

Description	Stock Code (M10)	Stock Code (M12)	Stock Code (M16)	Stock Code (M20)
30mm	XOX1030			
35mm	XOX1035			
40mm	XOX1040	XOX1240		
45mm	XOX1045	XOX1245		
50mm	XOX1050	XOX1250	XOX1650	
55mm	XOX1055	XOX1255		
60mm	XOX1060	XOX1260	XOX1660	XOX2060
65mm	XOX1065	XOX1265		
70mm	XOX1070	XOX1270	XOX1670	XOX2070
75mm	XOX1075	XOX1275		
80mm	XOX1080	XOX1280	XOX1680	XOX2080
90mm	XOX1090	XOX1290		
100mm	XOX10100	XOX12100	XOX16100	XOX20100
110mm	XOX10110	XOX12110		
120mm	XOX10120	XOX12120	XOX16120	XOX20120
130mm	XOX10130	XOX12130	XOX16130	XOX20130
140mm	XOX10140	XOX12140	XOX16140	XOX20140
150mm	XOX10150	XOX12150	XOX16150	XOX20150
160mm	XOX10160	XOX12160	XOX16160	XOX20160
170mm	XOX10170	XOX12170		
180mm	XOX10180	XOX12180	XOX16180	XOX20180
200mm	XOX10200	XOX12200	XOX16200	XOX20200
220mm	XOX10220	XOX12220	XOX16220	XOX20220
240mm	XOX10240	XOX12240		
260mm	XOX10260	XOX12260		
280mm	XOX10280	XOX12280		
300mm	XOX10300	XOX12300		



8.8 HIGH TENSILE ROOFING BOLTS BZP



Description	Stock Code (M6)	Stock Code (M8)
12	RB612	RB812
16	RB616	RB816
20	RB620	RB820
25	RB625	RB825
30	RB630	RB830
35	RB635	
40	RB640	RB840
45	RB645	
50	RB650	RB850
60	RB660	RB860
70	RB670	RB870
80	RB680	RB880
90	RB690	
100	RB6100	RB8100

M10 AND LONGER LENGTHS AVAILABLE

MACHINE SCREW ZINC



Description	Stock Code (PAN HEAD)	Stock Code (COUNTERSUNK)
M4 X6	MSP46	MSC46
M4 X10	MSP410	MSC410
M4 X15	MSP415	MSC415
M4 X20	MSP420	MSC420
M4 X25	MSP425	MSC425
M4 X30	MSP430	MSC430
M4 X40	MCP440	MSC440
M4 X50	MSP450	MSC450
M5 X10	MSP510	MSC510
M5 X15	MSP515	MSC515
M5 X20	MSP520	MSC520
M5 X25	MSP525	MSC525
M5 X30	MSP530	MSC530
M5 X40	MSP540	MSC540
M5 X50	MSP550	MSC550
M6 X12	MSP612	MSC612
M6 X16	MSP616	MSC616
M6 X20	MSP620	MSC620
M6 X25	MSP625	MSC625
M6 X30	MSP630	MSC630
M6 X40	MSP640	MSC640
M6 X50	MSP650	MSC650
M8 X20		MSC820
M8 X25		MSC825
M8 X30		MSC830
M8 X35		MSC835
M8 X40		MSC840
M8 X50		MSC850
M10 X25		MSC1025
M10 X30		MSC1030
M10 X40		MSC1040
M10 X50		MSC1050



HEX FULL NUTS



Description	Code (Bright Zinc)	Code (Stainless Steel)
M 4 Full Nuts	NUT4	NUT4SS
M5 Full Nuts	NUT5	NUT5SS
M6 Full Nuts	NUT6	NUT6SS
M8 Full Nuts	NUT8	NUT8SS
M10 Full Nuts	NUT10	NUT10SS
M12 Full Nuts	NUT12	NUT12SS
M16 Full Nuts	NUT16	NUT16SS
M20 Full Nuts	NUT20	NUT20SS

NYLOC NUTS



Description	Code (Bright Zinc)	Code (Stainless Steel)
M6 Nyloc Nuts	NYL6	NYL6SS
M8 Nyloc Nuts	NYL8	NYL8SS
M10 Nyloc Nuts	NYL10	NYL10SS
M12 Nyloc Nuts	NYL12	NYL12SS
M16 Nyloc Nuts	NYL16	NYL16SS



Description	Code (Bright Zinc)	Code (Stainless Steel)
SHEAR NUTS	STOCK CODE	
M8 SHEAR NUT	SHEAR8	
M10 SHEAR NUT	SHEAR10	
M12 SHEAR NUT	SHEAR12	

WING NUTS



Description	Stock Code
M4 Wing Nuts	WN4
M5 Wing Nuts	WN5
M6 Wing Nuts	WN6
M8 Wing Nuts	WN8
M10 Wing Nuts	WN10
M12 Wing Nuts	WN12

DOME NUTS



Description	Stock Code	STAINLESS STOCK CODE
M4 Bzp Dome Nut	DN4	DN4SS
M5 Bzp Dome Nut	DN5	DN5SS
M6 Bzp Dome Nut	DN6	DN6SS
M8 Bzp Dome Nut	DN8	DN8SS
M10 Bzp Dome Nut	DN10	DN10SS
M12 Bzp Dome Nut	DN12	DN12SS
M16 Full Nuts	NUT16	NUT16SS
M20 Full Nuts	NUT20	NUT20SS



NUTSERTS

Description	Stock Code
M4 NUTSERT	NS004
M5 NUTSERT	NS005
M6 NUTSERT	NS006
M8 NUTSERT	NS010
M10 NUTSERT	NS012



HALF NUTS

Description	Stock Code
M6 HALF NUT	HALF6
M8 HALF NUT	HALF8
M10 HALF NUT	HALF10
M12 HALF NUT	HALF12
M16 HALF NUT	HALF16



FLANGE NUTS

Description	Stock Code
M4 FLANGE NUTS	FLANGE4
M5 FLANGE NUTS	FLANGE5
M6 FLANGE NUTS	FLANGE6
M8 FLANGE NUTS	FLANGE8
M10 FLANGE NUTS	FLANGE10
M12 FLANGE NUTS	FLANGE12



XOX MILD STEEL PLATE WASHERS

Description	Stock Code
M12 x 50 x 50 Plate Washer	XOX125050
M16 x 50 x 50 Plate Washer	XOX165050



TIMBER CONNECTORS (GALVANISED)

Description	Stock Code
M12 X 50 Single	SSTC1250
M12 x 65 Single	SSTC1265
M12 x 50 Double	DSTC1250
M12 x 65 Double	DSTC1265
M12 x 75 Double	DSTC1275

WASHERS



Description	Code (Bright Zinc)	Code (Stainless Steel)
M4 Plain Washer	WASH4	WASH4SS
M5 Plain Washer	WASH5	WASH5SS
M6 Plain Washer	WASH6	WASH6SS
M8 Plain Washer	WASH8	WASH8SS
M10 Plain Washer	WASH10	WASH10SS
M12 Plain Washer	WASH12	WASH12SS
M16 Plain Washer	WASH16	WASH16SS
M20 Plain Washer	WASH20	WASH20SS

PENNY WASHERS



Description	Code (Bright Zinc)	Code (Stainless Steel)
M6 x 25 Bzp Penny Washers	WASH625	WASH625SS
M6 x 30 Bzp Penny Washers	WASH630	WASH630SS
M8 x 25 Bzp Penny Washers	WASH825	WASH825SS
M8 x 30 Bzp Penny Washers	WASH830	WASH830SS
M10 x 25 Bzp Penny Washers	WASH1025	WASH1025SS
M10 x 30 Bzp Penny Washers	WASH1030	WASH1030SS
M10 x 40 Bzp Penny Washers	WASH1040	WASH1040SS
M12 x 30 Bzp Penny Washers	WASH1230	WASH1230SS

SHAKEPROOF WASHERS



Description	Code (Bright Zinc)	Code (Stainless Steel)
M4 Shakeproof Washers	SPW4	SPW4SS
M5 Shakeproof Washers	SPW5	SPW5SS
M6 Shakeproof Washers	SPW6	SPW6SS
M8 Shakeproof Washers	SPW8	SPW8SS
M10 Shakeproof Washers	SPW10	SPW10SS
M12 Shakeproof Washers	SPW12	SPW12SS
M16 Shakeproof Washers	SPW16	SPW16SS
M20 Shakeproof Washers	SPW20	SPW20SS

SPRING COIL WASHERS



Description	Code (Bright Zinc)	Code (Stainless Steel)
M4 Spring Washer	SPR4	SPR4SS
M5 Spring Washer	SPR5	SPR5SS
M6 Spring Washer	SPR6	SPR6SS
M8 Spring Washer	SPR8	SPR8SS
M10 Spring Washer	SPR10	SPR10SS
M12 Spring Washer	SPR12	SPR12SS
M16 Spring Washer	SPR16	SPR16SS
M20 Spring Washer	SPR20	SPR20SS

ROUNDWIRE NAIL

Description	Stock Code (Galv)	Stock Code (Bright)
40mm x 2.36	GRW40	BRW40
50mm x 2.65	GRW50	BRW50265
65mm x 2.65	GRW65265	BRW65265
65mm x 3.35	GRW65335	BRW65265
75mm x 3.35	GRW75335	BRW75335
75mm x 3.75	GRW75375	BRW755
100mm x 4.50	GRW100	BRW100
150mm x 6.00	GRW150	BRW150

BRIGHT LOST HEAD NAILS

Description	Stock Code
40mm x 2.36 Lost Head Nails	BLH40
65mm x 3.35 Lost Head Nails	BLH65
75mm x 3.35 Lost Head Nails	BLH75

SHERADISED LOST HEAD NAILS AVAILABLE TO ORDER

OVAL BRADS

Description	Stock Code
25mm Oval Brads	OVB25
40mm Oval Brads	OVB40
50mm Oval Brads	OVB50

ANNULAR RING SHANK NAIL

Description	Stock Code	Stock Code (Stainless)
40mm Bright Ring Shank Nails	ARS40	ARS49SS
50mm Bright Ring Shank Nails	ARS50	ARS50SS
65mm Bright Ring Shank Nails	ARS65	ARS65SS

CLOUT NAILS

Description	Stock Code	Stock Code (Stainless)	Stock Code (Copper)
40mm x 2.65	CLOUT40265	CLOUT40265SS	CLOUT40C
40mm x 3.35	CLOUT40335	CLOUT40335SS	

SQUARE TWIST NAILS

Description	Stock Code
30mm x 3.75 Square Twisted Nail	SQT30

PANEL PINS

Description	Stock Code (Bright)	Stock Code (Sheradised)
20mm x 1.6 Panel Pins	PANEL20	
25mm x 1.6 Panel Pins	PANEL25	PANEL25S
30mm x 1.6 Panel Pins	PANEL30	PANEL30S
40mm x 1.6 Panel Pins	PANEL40	PANEL40S
50mm x 2.0 Panel Pins	PANEL50	PANEL50S

STANDARD TIMBER JOIST HANGER CAN TAKE UP TP 225 MM DEEP JOISTS



Description	Stock Code
38 MM STANDARD TIMBER JOIST HANGER	JIF38
50 MM STANDARD TIMBER JOIST HANGER	JIF50
63 MM STANDARD TIMBER JOIST HANGER	JIF63
75 MM STANDARD TIMBER JOIST HANGER	JIF75
100 MM STANDARD TIMBER JOIST HANGER	JIF100
150 MM STANDARD TIMBER JOIST HANGER	JIF150

LONG LEG TIMBER JOIST HANGER EITHER 450MM OR 600MM LEG LENGTH



Description	Stock Code
38 MM LONG LEG JOIST HANGER	JIF38LL
50 MM LONG LEG JOIST HANGER	JIF50LL
63 MM LONG LEG JOIST HANGER	JIF63LL
75 MM LONG LEG JOIST HANGER	JIF75LL
100 MM LONG LEG JOIST HANGER	JIF100LL
150 MM LONG LEG JOIST HANGER	JIF150LL

MINI JOIST HANGERS AND TRUSS CLIPS (MINI UP TO 150MM JOIST HEIGHT)



Description	Stock Code
MINI JOIST HANGER 38 MM	MINI38
MINI JOIST HANGER 44 MM	MINI44
MINI JOIST HANGER 50 MM	MINI50
38 MM TRUSS CLIP	TRUSS38
50 MM TRUSS CLIP	TRUSS50

MASONRY HANGERS (OTHER SIZES AVAILABLE)



HANGERS ABOVE 150 MM MANUFACTURED 10MM LESS TO ALLOW FOR NOTCHING

Description	Height	Height	Height	Height	Height	Height
50 MM JOIST WIDTH (47MM)	100 MM	125 MM	140 MM	165 MM	190 MM	215 MM
75 MM JOIST WIDTH			140 MM	165 MM	190 MM	215 MM
100 MM JOIST WIDTH			140 MM	165 MM	190 MM	215 MM
150 MM JOIST WIDTH					190 MM	215 MM

MULTI FUNCTIONAL FACE FIT HANGERS

HANGERS ABOVE 150 MM MANUFACTURED 10MM LESS TO ALLOW FOR NOTCHING



Description	Ht/Overall L	Ht/Overall L	Ht/Overall L	Ht/Overall L
50 MM FACE FIT MFH HANGER (47 MM)	97/240 MM	150/346 MM	179/404 MM	229/504 MM
76 MM FACE FIT MFH HANGER	135/346 MM		164/404 MM	214/504 MM
100 MM FACE FIT MFH HANGER		123/346 MM	152/404 MM	202/504 MM
150 MM FACE FIT MFH HANGER			127/404 MM	177/504 MM

RESTRAINT STRAPS HEAVY DUTY 4 MM THICK LIGHT DUTY 2.4 MM THICK



Description	Stock Code (Heavy Duty)	Stock Code (Light Duty)
FLAT RESTRAINT STRAP 1000 MM	HD10	LD10
FLAT RESTRAINT STRAP 1200 MM	HD12	LD12
FLAT RESTRAINT STRAP 1500 MM	HD15	

RESTRAINT STRAP 1000MM BENT 100MM	HD10B1	LD10B1
RESTRAINT STRAP 1000MM BENT 150MM	HD10B15	LD10B15
RESTRAINT STRAP 1200MM BENT 100MM	HD12B1	LD12B1
RESTRAINT STRAP 1200MM BENT 150MM	HD12B15	

TWISTED RESTRAINT STRAP 600MM TWIST 100MM	HD6T1	LD6T1
TWISTED RESTRAINT STRAP 1000MM TWIST 100MM	HD10T1	LD10T1

ANGLE BRACKETS AND NAIL PLATES



Description	Stock Code
ANGLE BRACKET 50 X 50 MM	AB5050
ANGLE BRACKET 60 X 40 MM	AB6040
ANGLE BRACKET 90 X 90 MM	AB9090
ANGLE BRACKET 150 X 90 MM	AB15090
ANGLE BRACKET 150 X 150 MM	AB150150

42 X 178 MM NAIL PLATE	NP42
85 X 178 MM NAIL PLATE	NP85
104 X 154 MM NAIL PLATE	NP104
169 X 178 MM NAIL PLATE	NP169
178 X 338 MM NAIL PLATE	NP178



20 MM X 10 METRE GALV FIXING BAND	ARBGALV
17 MM X 10 METRE BLACK ALL ROUND BAND	ARBBLACK

SDS DRILL BITS



Description	Stock Code
5 x 110 SDS Hammer Drill	SDS5110
5 x 160 SDS Hammer Drill	SDS5160
5.5 x 110 SDS Hammer Drill	SDS55110
5.5 x 160 SDS Hammer Drill	SDS55160
6 x 110 SDS Hammer Drill	SDS6110
6 x 160 SDS Hammer Drill	SDS6160
6 x 210 SDS Hammer Drill	SDS6210
6.5 x 110 SDS Hammer Drill	SDS65110
6.5 x 160 SDS Hammer Drill	SDS65160
7 x 110 SDS Hammer Drill	SDS7110
7 x 160 SDS Hammer Drill	SDS7160
7 x 210 SDS Hammer Drill	SDS7210
8 x 110 SDS Hammer Drill	SDS8110
8 x 160 SDS Hammer Drill	SDS8160
8 x 210 SDS Hammer Drill	SDS8210
8 x 260 SDS Hammer Drill	SDS8260
8 x 460 SDS Hammer Drill	SDS8460
9 x 210 SDS Hammer Drill	SDS9210
10 x 160 SDS Hammer Drill	SDS10160
10 x 210 SDS Hammer Drill	SDS10210
10 x 260 SDS Hammer Drill	SDS10260
10 x 300 SDS Hammer Drill	SDS10300
10 x 460 SDS Hammer Drill	SDS10460
10 x 600 SDS Hammer Drill	SDS10600
10 x 1000 SDS Hammer Drill	SDS101000
11 x 160 SDS Hammer Drill	SDS11160
11 x 300 SDS Hammer Drill	SDS11300
12 x 160 SDS Hammer Drill	SDS12160
12 x 230 SDS Hammer Drill	SDS12230
12 x 300 SDS Hammer Drill	SDS12300
12 x 460 SDS Hammer Drill	SDS12460
12 x 600 SDS Hammer Drill	SDS12600
12 x 1000 SDS Hammer Drill	SDS13160
13 x 160 SDS Hammer Drill	SDS13160
13 x 460 SDS Hammer Drill	SDS13460
14 x 160 SDS Hammer Drill	SDS14160
14 x 230 SDS Hammer Drill	SDS14230
14 x 300 SDS Hammer Drill	SDS14300
14 x 460 SDS Hammer Drill	SDS14460
14 x 600 SDS Hammer Drill	SDS14600
14 x 1000 SDS Hammer Drill	SDS14100

Description	Stock Code
15 x 160 SDS Hammer Bit	SDS15160
15 x 230 SDS Hammer Bit	SDS15230
15 x 300 SDS Hammer Bit	SDS15300
16 x 160 SDS Hammer Bit	SDS16160
16 x 230 SDS Hammer Bit	SDS16230
16 x 300 SDS Hammer Bit	SDS16300
16 x 460 SDS Hammer Bit	SDS16460
16 x 600 SDS Hammer Bit	SDS16600
16 x 1000 SDS Hammer Bit	SDS161000
18 x 200 SDS Hammer Bit	SDS18200
18 x 300 SDS Hammer Bit	SDS18300
18 x 460 SDS Hammer Bit	SDS18460
18 x 1000 SDS Hammer Bit	SDS181000
19 x 200 SDS Hammer Bit	SDS19200
19 x 300 SDS Hammer Bit	SDS19300
19 x 460 SDS Hammer Bit	SDS19460
20 x 200 SDS Hammer Bit	SDS20200
20 x 300 SDS Hammer Bit	SDS20300
20 x 460 SDS Hammer Bit	SDS20460
20 x 600 SDS Hammer Bit	SDS20600
20 x 1000 SDS Hammer Bit	SDS201000
22 x 300 SDS Hammer Bit	SDS22300
22 x 460 SDS Hammer Bit	SDS22460
22 x 1000 SDS Hammer Bit	SDS221000
24 x 300 SDS Hammer Bit	SDS24300
24 x 460 SDS Hammer Bit	SDS24460
25 x 300 SDS Hammer Bit	SDS25300
25 x 460 SDS Hammer Bit	SDS25460
26 x 300 SDS Hammer Bit	SDS26300
26 x 460 SDS Hammer Bit	SDS26460
26 x 600 SDS Hammer Bit	SDS26600
30 X 460 SDS Hammer Bit	SDS30460
25 x 300 SDS Hammer Bit	SDS25300
25 x 460 SDS Hammer Bit	SDS25460
26 x 300 SDS Hammer Bit	SDS26300
26 x 460 SDS Hammer Bit	SDS26460
26 x 600 SDS Hammer Bit	SDS26600
30 X 460 SDS Hammer Bit	SDS30460

SDS MAX DRILL BITS OTHER SIZES AVAILABLE



Description	Stock Code
18 X 540 SDS MAX DRILL BIT	SDS18520MAX
20 X 520 SDS MAX DRILL BIT	SDS20520MAX
22 X 520 SDS MAX DRILL BIT	SDS22520MAX
24 X 520 SDS MAX DRILL BIT	SDS24520MAX
25 X 520 SDS MAX DRILL BIT	SDS25520MAX
25 X 920 SDS MAX DRILL BIT	SDS25920MAX
26 X 520 SDS MAX DRILL BIT	SDS26520MAX
28 X 520 SDS MAX DRILL BIT	SDS28520MAX
28 X 920 SDS MAX DRILL BIT	SDS28920MAX
30 X 520 SDS MAX DRILL BIT	SDS30520MAX
32 X 520 SDS MAX DRILL BIT	SDS32520MAX
32 X 920 SDS MAX DRILL BIT	SDS32920MAX
38 X 520 SDS MAX DRILL BIT	SDS38520MAX
40 X 520 SDS MAX DRILL BIT	SDS40520MAX
45 X 520 SDS MAX DRILL BIT	SDS45520MAX
50 X 520 SDS MAX DRILL BIT	SDS508520MAX



POINTS AND CHISELS TO FIT SUITABLE SDS HAMMER DRILLS

Description	Stock Code
SDS FIT CHISEL	SDSC
SDS FIT POINT	SDSP
SDS FIT BOLSTER CHISEL 40MM	SDSB
SDS FIT GUAGE	SDSG

REBAR CUTTERS	
12 MM EXTREME REBAR CUTTER	RBB12
14 MM EXTREME REBAR CUTTER	RBB14
16 MM EXTREME REBAR CUTTER	RBB16
18MM EXTREME REBAR CUTTER	RBB18
20 MM EXTREME REBAR CUTTER	RBB20
25 MM EXTREME REBAR CUTTER	RBB25
28 MM EXTREME REBAR CUTTER	RBB28
30 MM EXTREME REBAR CUTTER	RBB30

SDS REBAR CUTTER ADAPTOR

RBBSDSA

DIAMOND CORE BITS



Description	Stock Code
32 x 150mm Diamond Core Bit	DCB032
38 x 150mm Diamond Core Bit	DCB038
52 x 150mm Diamond Core Bit	DCB052
65 x 150mm Diamond Core Bit	DCB065
78 x 150mm Diamond Core Bit	DCB078
107 x 150mm Diamond Core Bit	DCB107
117 x 150mm Diamond Core Bit	DCB117
127 x 150mm Diamond Core Bit	DCB127
152 x 150mm Diamond Core Bit	DCB152

DIAMOND CORE ACCESSORIES



Description	Stock Code
Diamond Core Bit Adaptor Pack	AP02
250mm Extension Rod	EX250
Guide Rod For Diamond Core	GROD
13mm x 400 Pilot Rod	EX13400
SDS Extension Rod 100mm	EXSDS100
SDS Extension Rod 250mm	EXSDS300
Short Hex Diamond core Adaptor	SHA
Long hex Diamond Core Adaptor	LHA
Short SDS Diamond core Adaptor	SSDSA
Long SDS Diamond Core Adaptor	LSDSA

MINI DIAMOND CORE BITS FOR DRILLING PORCELAIN, CERAMICS, GLASS, SLATE AND MARBLE

ALSO AVAILABLE WITH INTEGRATED LUBRICANT
FOR GREATER PERFORMANCE

Description	Stock Code	Stock Code (Lubricated)
5MM MINI DIAMOND CORE BIT	MDC5	MDC5W
6MM MINI DIAMOND CORE BIT	MDC6	MDC6W
7MM MINI DIAMOND CORE BIT	MDC7	MDC7W
8MM MINI DIAMOND CORE BIT	MDC8	MDC8W
10MM MINI DIAMOND CORE BIT	MDC10	MDC10W
12MM MINI DIAMOND CORE BIT	MDC12	MDC12W
15MM MINI DIAMOND CORE BIT	MDC15	MDC15W
20MM MINI DIAMOND CORE BIT	MDC20	MDC20W
25MM MINI DIAMOND CORE BIT	MDC25	MDC25W
32MM MINI DIAMOND CORE BIT	MDC32	
38MM MINI DIAMOND CORE BIT	MDC38	
45MM MINI DIAMOND CORE BIT	MDC45	
50MM MINI DIAMOND CORE BIT	MDC50	
54MM MINI DIAMOND CORE BIT	MDC54	
63MM MINI DIAMOND CORE BIT	MDC63	
83MM MINI DIAMOND CORE BIT	MDC83	
115MM MINI DIAMOND CORE BIT	MDC115	



TILE AND GLASS DRILL BITS (ARROW TIP)

Description	Stock Code
3MM GLASS AND TILE BIT	TILEB3
4MM GLASS AND TILE BIT	TILEB4
5MM GLASS AND TILE BIT	TILEB5
6MM GLASS AND TILE BIT	TILEB6
7MM GLASS AND TILE BIT	TILEB7
8MM GLASS AND TILE BIT	TILEB8
10MM GLASS AND TILE BIT	TILEB10
13MM GLASS AND TILE BIT	TILEB13
14MM GLASS AND TILE BIT	TILEB14



HSS DRILL BITS METRIC SIZES



Description	Stock Code
2.0mm HSS Drill Bit	HSS2
2.3mm HSS Drill Bit	HSS23
2.5mm HSS Drill Bit	HSS25
2.9mm HSS Drill Bit	HSS29
3.0mm HSS Drill Bit	HSS3
3.1mm HSS Drill Bit	HSS31
3.2mm HSS Drill Bit	HSS32
3.3mm HSS Drill Bit	HSS33
3.4mm HSS Drill Bit	HSS34
3.5mm HSS Drill Bit	HSS35
3.6mm HSS Drill Bit	HSS36
3.7mm HSS Drill Bit	HSS37
3.8mm HSS Drill Bit	HSS38
3.9mm HSS Drill Bit	HSS39
4.0mm HSS Drill Bit	HSS4
4.1mm HSS Drill Bit	HSS41
4.2mm HSS Drill Bit	HSS42
4.3mm HSS Drill Bit	HSS43
4.4mm HSS Drill Bit	HSS44
4.5mm HSS Drill Bit	HSS45
4.6mm HSS Drill Bit	HSS46
4.7mm HSS Drill Bit	HSS47
4.8mm HSS Drill Bit	HSS48
4.9mm HSS Drill Bit	HSS49
5.0mm HSS Drill Bit	HSS5
5.2mm HSS Drill Bit	HSS52
5.5mm HSS Drill Bit	HSS55
6.0mm HSS Drill Bit	HSS6
6.2mm HSS Drill Bit	HSS62
6.5mm HSS Drill Bit	HSS65
6.6mm HSS Drill Bit	HSS66
6.8mm HSS Drill Bit	HSS68

Description	Stock Code
7.0mm HSS Drill Bit	HSS7
7.1mm HSS Drill Bit	HSS71
7.2mm HSS Drill Bit	HSS72
7.5mm HSS Drill Bit	HSS75
7.8mm HSS Drill Bit	HSS78
8.0mm HSS Drill Bit	HSS8
8.2mm HSS Drill Bit	HSS82
8.5mm HSS Drill Bit	HSS85
8.8mm HSS Drill Bit	HSS88
9.0mm HSS Drill Bit	HSS9
9.4mm HSS Drill Bit	HSS94
9.5mm HSS Drill Bit	HSS95
10mm HSS Drill Bit	HSS10
10.2mm HSS Drill Bit	HSS102
10.5 HSS Drill Bit	HSS105
11.0 HSS Drill Bit	HSS11
11.5 HSS Drill Bit	HSS115
12.0 HSS Drill Bit	HSS12
12.5 HSS Drill Bit	HSS125
13.0 HSS Drill Bit	HSS13

HSS COBALT DRILL BITS



Description	Stock Code
1.0mm Cobalt Drill Bit	COB1
1.5mm Cobalt Drill Bit	COB15
2.0mm Cobalt Drill Bit	COB2
2.5mm Cobalt Drill Bit	COB25
3.0mm Cobalt Drill Bit	COB3
3.2mm Cobalt Drill Bit	COB32
3.3mm Cobalt Drill Bit	COB33
3.5mm Cobalt Drill Bit	COB35
4.0mm Cobalt Drill Bit	COB4
4.2mm Cobalt Drill Bit	COB42
4.5mm Cobalt Drill Bit	COB45
4.8mm Cobalt Drill Bit	COB48
5.0mm Cobalt Drill Bit	COB50
5.5mm Cobalt Drill Bit	COB55
6.0mm Cobalt Drill Bit	COB6
6.5mm Cobalt Drill Bit	COB65
7.0mm Cobalt Drill Bit	COB7
7.5mm Cobalt Drill Bit	COB75
8.0mm Cobalt Drill Bit	COB8
8.5mm Cobalt Drill Bit	COB85
9.0mm Cobalt Drill Bit	COB9
9.5mm Cobalt Drill Bit	COB95
10mm Cobalt Drill Bit	COB10
10.5mm Cobalt Drill Bit	COB105
11.0mm Cobalt Drill Bit	COB11
11.5mm Cobalt Drill Bit	COB115
12mm Cobalt Drill Bit	COB12
12.5mm Cobalt Drill Bit	COB125
13mm Cobalt Drill Bit	COB13

HSS BLACKSMITH DRILL BITS



Description	Stock Code
14mm Blacksmith Bit	BSDB14
15mm Blacksmith Bit	BSDB15
16mm Blacksmith Bit	BSDB16
18mm Blacksmith Bit	BSDB18
20mm Blacksmith Bit	BSDB20
22mm Blacksmith Bit	BSDB22
25mm Blacksmith Bit	BSDB25

METRIC TAP



Description	Stock Code	Drill Bit
3.0mm Second Tap	TAP3	2.5MM
3.5mm Second Tap	TAP35	2.9MM
4.0mm Second Tap	TAP4	3.3MM
5.0mm Second Tap	TAP5	4.3MM
6.0mm Second Tap	TAP6	5MM
8.0mm Second Tap	TAP8	6.8MM
10.0mm Second Tap	TAP10	8.5MM
12.0mm Second Tap	TAP12	10.2MM

MAGNETIC DRILL BROACHING CUTTERS

Description	Stock Code (short)	Stock Code (long)
12MM MAGNETIC DRILL BROACHING CUTTER	MAG12S	MAG12L
13MM MAGNETIC DRILL BROACHING CUTTER	MAG13S	MAG13L
14MM MAGNETIC DRILL BROACHING CUTTER	MAG14S	MAG14L
15MM MAGNETIC DRILL BROACHING CUTTER	MAG15S	MAG15L
16MM MAGNETIC DRILL BROACHING CUTTER	MAG16S	MAG16L
17MM MAGNETIC DRILL BROACHING CUTTER	MAG17S	MAG17L
18MM MAGNETIC DRILL BROACHING CUTTER	MAG18S	MAG18L
19MM MAGNETIC DRILL BROACHING CUTTER	MAG19S	MAG19L
20MM MAGNETIC DRILL BROACHING CUTTER	MAG20S	MAG20L
21MM MAGNETIC DRILL BROACHING CUTTER	MAG21S	MAG21L
22MM MAGNETIC DRILL BROACHING CUTTER	MAG22S	MAG22L
23MM MAGNETIC DRILL BROACHING CUTTER	MAG23S	MAG23L
24MM MAGNETIC DRILL BROACHING CUTTER	MAG24S	MAG24L
25MM MAGNETIC DRILL BROACHING CUTTER	MAG25S	MAG25L
26MM MAGNETIC DRILL BROACHING CUTTER	MAG26S	MAG26L
27MM MAGNETIC DRILL BROACHING CUTTER	MAG27S	MAG27L
28MM MAGNETIC DRILL BROACHING CUTTER	MAG28S	MAG28L
30MM MAGNETIC DRILL BROACHING CUTTER	MAG30S	MAG30L
32MM MAGNETIC DRILL BROACHING CUTTER	MAG32S	MAG32L
35MM MAGNETIC DRILL BROACHING CUTTER	MAG35S	MAG35L
38MM MAGNETIC DRILL BROACHING CUTTER	MAG38S	MAG38L
40MM MAGNETIC DRILL BROACHING CUTTER	MAG40S	MAG40L
50MM MAGNETIC DRILL BROACHING CUTTER	MAG50S	MAG50L



CHUCKS

Description	Stock Code
1/2" Chuck And Key	CHUCK
1/2" Keyless Chuck	KLCHUCK
1/2" Chuck & SDS Adaptor	CHSDS
1/2" Keyless Chuck & Adaptor	CHSDSKL



STEP DRILLS CONE CUTTERS AND COUNTERSINKS

Description	Stock Code
4 - 22 MM STEP DRILL 10 STEPS	CS30
6 - 30 MM STEP DRILL 13 STEPS	CS31
4 - 12 MM STEP DRILL 9 STEPS	CS32
5 - 38 MM STEP DRILL 14 STEPS	CS33
3 - 14 MM CONE CUTTER	HCC01
6 - 30 MM CONE CUTTER	HCC03
1/4" COUNTERSINK	CSK01
3/8" COUNTERSINK	CSK02
1/2" COUNTERSINK	CSK03
5/8" COUNTERSINK	CSK04



BI-METAL HOLESAWS



Description	Stock Code
14mm Bi-Metal Holesaw	HS014
16mm Bi-Metal Holesaw	HS016
20mm Bi-Metal Holesaw	HS020
22mm Bi-Metal Holesaw	HS022
25mm Bi-Metal Holesaw	HS025
30mm Bi-Metal Holesaw	HS030
32mm Bi-Metal Holesaw	HS032
35mm Bi-Metal Holesaw	HS035
38mm Bi-Metal Holesaw	HS038
51mm Bi-Metal Holesaw	HS051
60mm Bi-Metal Holesaw	HS060
70mm Bi-Metal Holesaw	HS070
79mm Bi-Metal Holesaw	HS079
102mm Bi-Metal Holesaw	HS102
127mm Bi-Metal Holesaw	HS127
152mm Bi-Metal Holesaw	HS152

ALL OTHER SIZES AVAILABLE

HOLESAW ARBORS



Description	Stock Code
14 - 30mm Holesaw Arbor	HSA01
32 - 152mm Holesaw Arbor	HSA02
14 - 30mm SDS Hole Saw Arbor	SDSA1
32 -152mm SDS Hole Saw Arbor	SDSA2



HOLESAW EXTENSIONS

Description	Stock Code
300mm Holesaw Arbor Extension	HSAEX
Holesaw Pilot Bit	HSPB

FLAT WOOD BITS



Description	Stock Code
6mm Flat Wood Bit	FWB06
8mm Flat Wood Bit	FWB08
10mm Flat Wood Bit	FWB10
13mm Flat Wood Bit	FWB13
16mm Flat Wood Bit	FWB16
19mm Flat Wood Bit	FWB19
20mm Flat Wood Bit	FWB20
22mm Flat Wood Bit	FWB22
25mm Flat Wood Bit	FWB25
28mm Flat Wood Bit	FWB28
32mm Flat Wood Bit	FWB32
35mm Flat Wood Bit	FWB35
38mm Flat Wood Bit	FWB38
12" Flat Wood Bit Extension	FWBEX

WOOD AUGER BITS 205MM



Description	Stock Code
6 X 205mm Wood Auger	WA6205
8 x 205mm Wood Auger	WA8205
10 x 205mm Wood Auger	WA10205
12 x 205mm Wood Auger	WA12205
13 x 205mm Wood Auger	WA13205
16 x 205mm Wood Auger	WA16205
20 x 205mm Wood Auger	WA20205
22 x 205mm Wood Auger	WA22205
25 x 205mm Wood Auger	WA25205
32 x 205mm Wood Auger	WA32205
38 x 205mm Wood Auger	WA38205

WOOD AUGER BITS 480MM



Description	Stock Code
8 x 480mm Wood Auger	WA8480
10 x 480mm Wood Auger	WA10480
12 x 480mm Wood Auger	WA12480
16 x 480mm Wood Auger	WA16480
20 x 480mm Wood Auger	WA20480
22 x 480mm Wood Auger	WA22480
25 x 480mm Wood Auger	WA25480
32 x 480mm Wood Auger	WA32480
38 x 480mm Wood Auger	WA38480

WOOD AUGER BITS SDS 205MM



Description	Stock Code
6 x 205mm Sds Wood Auger	WASDS06
8 x 205mm Sds Wood Auger	WASDS08
10 x 205mm Sds Wood Auger	WASDS10
12 x 205mm Sds Wood Auger	WASDS12
13 x 205mm Sds Wood Auger	WASDS13
15 x 205mm Sds Wood Auger	WASDS15
16 x 205mm Sds Wood Auger	WASDS16
20 x 205mm Sds Wood Auger	WASDS20
22 x 205mm Sds Wood Auger	WASDS22
25 x 205mm Sds Wood Auger	WASDS25

RECIPROCATING SAW BLADES

Description	Stock Code
S992AF 150 x 24T Metal 0.7 - 3mm (5)	S922AF
S992EF 150 x 18T Metal 1.5 - 4.6mm (5)	S922EF
S992VF 150 Wood/Metal 10 - 14 mm (5)	S922VF
S1122AF 225 x 24T Metal 0.7 - 3mm (5)	S1122AF
S1122BF 225 x 14T Metal 3 - 8mm (5)	S1122BF
S1122EF 225 x 18T Metal 1.5 - 4mm (5)	S1122EF
S1222VF 300 Metal/Wood 10 - 14mm (5)	S1222VF
S1531L 240 x 5T Wood	S1531L

JIGSAW BLADES - WOOD CUTTING

Description	Stock Code
SCROLL CUTTER FOR WOOD	T101AO
MEDIUM CLEAN CUT FOR WOOD	T101B
DOWN CUTTER REVERSE BLADE FOR WOOD	T101BR
CLEAN CUT FOR WOOD	T101D
FAST CUT FOR WOOD	T111C
BASIC FOR WOOD	T119B
FAST CUT FOR WOOD	T144DP
PRECISION CUT FOR WOOD	T144DP
LONGER BLADE FOR PROGRE- SIVE CLEAN CUT FOR WOOD	T234X
LONGER BLADE FOR EXTRA CLEAN FOR WOOD	T308B
LONGER BLADE CLEAN CUT FOR WOOD	T301CD
LONGER BLADE ROUGHER SPEED CUT FOR WOOD	T344D
LONGER BLADE SPEED CUT FOR HARD WOOD	T344DF
LONGER BLADE FOR CUTTING WOOD AND METAL	T345XF

JIGSAW BLADES - METAL CUTTING

Description	Stock Code
BASIC FOR METAL 1 - 3 MM THICK	T118A
BASIC FOR METAL 2.5 - 6 MM THICK	T118B
BASIC FOR METAL 0.5 - 1.5 MM THICK	T118G
FAST CUT FOR METAL	T123X
SCROLL BLADE FOR METAL	T218A
LONGER BLADE BASIC FOR METAL	T318A
FAST CUT FOR ALU	T127D
SCROLL BLADE FOR ALU	T227D

JIGSAW BLADES - SPECIALIST CUTTING

Description	Stock Code
FOR ACRYLIC	T101A
FOR FIBRE AND PLASTER	T141HM
FOR CERAMICS	T150RF
FOR STAINLESS STEEL	T118AHM





BI-METAL HACKSAW BLADES

Description	Stock Code
18 TPI Bi-Metal Hacksaw Blades	HB18
24 TPI Bi-Metal Hacksaw Blades	HB24
32 TPI Bi-Metal Hacksaw Blades	HB32



JUNIOR HACKSAW AND COPING SAW BLADES

Description	Stock Code
6" Coping Saw Blade	CSB
12" Heavy Duty Hacksaw Frame	HSF02
6" Junior Hacksaw Blades	JHSB02
Junior Hacksaw Frame	JHSF02



KNIVES AND BLADES

Description	Stock Code
Stanley knife (Fixed Blade)	STN002
Stanley Knife (Retractable Blade)	STN004
Titan Stanley Knife	STN006
Stanley Knife Blades	STN008



HARD POINT WOOD SAW

Description	Stock Code
20" Hard Point Jack Saw 880	JA04
22" Hard Point Jack Saw 990	JA06
22" Hard Point Jack Saw 770	JA08
20" Hard Point Saw Sandvik 244	SAN02
22" Hard Point Saw Sandvik 244	SAN04

CIRCULAR SAW BLADES FOR WOOD



Stock Code	Diameter	Bore Size	Teeth
C1362020	136MM	20	20
C1602024	160MM	20	24
C1651624	165MM	16	24
C1652024	165MM	20	24
C1652040	165MM	20	40
C1653024	165MM	30	24
C1653040	165MM	30	40
C1841628	184MM	16	28
C1841640	184MM	16	40
C1843028	184MM	30	28
C1843040	184MM	30	40
C1902028	190MM	20	28
C1902040	190MM	20	40
C1903028	190MM	30	28
C1903040	190MM	30	40
C1903060	190MM	30	60
C2163040	216MM	30	40
C2163060	216MM	30	60
C2353028	235MM	30	28
C2353040	235MM	30	40
C2353060	235MM	30	60
C2503040	250MM	30	40
C2503060	250MM	30	60
C2603060	260MM	30	60
C3053032	305MM	30	32
C3053060	305MM	30	60
C3053096	305MM	30	96
C1602048 (FITS FESTOOL T55)	160MM	20	48
C1652048 (FITS MAKITA 5603R 5604R)	165MM	20	48

CIRCULAR SAW BLADES FOR ALUMINIUM



Stock Code	Diameter	Bore Size	Teeth
C1602048A	160MM	20	48
C1652048A	165MM	20	48
C1841648A	184MM	16	48
C1903048A	190MM	30	48
C2163060A	216MM	30	60
C2353056A	235MM	30	56
C2503080A	250MM	30	80
C2603080A	300MM	30	80
C30030100A		30	100

CIRCULAR SAW BLADES FOR METAL



Stock Code	Diameter	Bore Size	Teeth
C1362032M	136MM	20	32
C1652040M	165MM	20	40
C1802036M	180MM	20	36
C1853038M	185MM	30	38
C23025444M	230MM	25.4	44
C25525444M	255MM	25.4	44
C30525460M	305MM	25.4	60
C35525472M	355MM	25.4	72
C3553072M	355MM	30	72

BLADES FOR EVOLUTION SAWS



Description	Diameter	Bore Size	Stock Code
RAGE MULTI PURPOSE BLADE 185	185MM	20MM	RAGE185
RAGE MULTI PURPOSE BLADE 210	210MM	25.4MM	RAGE210
RAGE MULTI PURPOSE BLADE 230	230MM	25.4MM	RAGE230
RAGE MULTI PURPOSE BLADE 255	255MM	25.4MM	RAGE255
EVOLUTION STEEL BLADE 180	180MM	20MM	EVO180
EVOLUTION STEEL BLADE 230	230MM	25.4MM	EVO230
EVOLUTION STEEL BLADE 255	255MM	25.4MM	EVO255
EVOLUTION STEEL BLADE 355	355MM	25.4MM	EVO355
EVOLUTION STAINLESS STEEL BLADE 180	180MM	20MM	EVO180SS
EVOLUTION STAINLESS STEEL BLADE 230	230MM	25.4MM	EVO230SS
EVOLUTION STAINLESS STEEL BLADE 355	355MM	25.4MM	EVO355SS

POLY CRYSTALLINE DIAMOND (PCD) SAW BLADES

POLY CRYSTALLINE DIAMOND (PCD) SAW BLADES FOR CUTTING FIBRE CEMENT BOARDS AND ULTRA HARD MATERIALS SUCH AS HARDIEPLANK, MINERIT, ETERNIT, MDF AND CORIAN. BLADES MUST NEVER PROTRUDE MORE THAN 1MM OUT OF THE BOTTOM OF THE SUBSTRATE.



Description	Teeth	BORE SIZE	STOCK CODE
160 MM PCD BLADE	4	20MM	PCD160204
160MM PCD BLADE	8	20MM	PCD160208
160MM PCD BLADE	4	30MM	PCD160304
165MM PCD BLADE	4	30MM	PCD165304
185MM PCD BLADE	4	16MM	PCD185164
190MM PCD BLADE	4	20MM	PCD190204
190MM PCD BLADE	8	20MM	PCD190208
190MM PCD BLADE	4	30MM	PCD190308
190MM PCD BLADE	8	30MM	PCD190308
216MM PCD BLADE	8	30MM	PCD216308
230MM PCD BLADE	6	20MM	PCD230206
230MM PCD BLADE	6	30MM	PCD230306
250MM PCD BLADE	6	30MM	PCD250306
300MM PCD BLADE	8	30MM	PCD300308



STONE CUTTING DISCS

Description	Stock Code
100MM X 3MM X 16MM	CDS4
115MM X 3MM X 22MM	CDS412
178MM X 3MM X 22MM	CDS7
230MM X 3MM X 22MM	CDS9
300MM X 4MM X 22MM	CDS1278
300MM X 4MM X 20MM	CDS1220



METAL CUTTING DISCS

Description	Stock Code
100MM X 3MM X 16MM	CDM4
115 MM X 1 MM X 22MM	INOX412
115MM X 3MM X 22MM	CDM412
178MM X 3MM X 22MM	CDM7
230MM X 1.8MM X 22MM	INOX9
230MM X 3MM X 22MM	CDM9
300MM X 4MM X 22MM	CDM1278
300MM X 4MM X 20MM	CDM1220
350MM X 4MM X 25MM	CDM14



METAL GRINDING DISCS

Description	Stock Code
100MM X 6MM X 16MM	GDM4
115MM X 6MM X 22MM	GMD412
125MM X 6MM X 22MM	GDM5
178MM X 6MM X 22MM	GDM7
230MM X 6MM X 22MM	GDM9



DIAMOND DISCS

BUDGET GENERAL PURPOSE BLADES	STOCK CODE
4½" 115MM	DBB115
9" 230MM	DBB230
12" 300MM	DBB300

TURBO GENERAL PURPOSE BLADE	STOCK CODE
4½" 115MM	DBP115
9" 230MM	DBP230
12" 300MM	DBP300

TURBO GREEN FOR HARD MATERIALS	STOCK CODE
4½" 115MM	DBTG115
9" 230MM	DBGT230
12" 300MM	DBGT300



DRYWALL CIRCLE DISCS FOR DRYWALL SANDING MACHINES

Description	Stock Code
225 MM X 80 GRIT	CIRCLEP80
225 MM X 100 GRIT	CIRCLEP100
225 MM X 120GRIT	CIRCLEP120



DRYWALL POLE SANDER SHEETS

Description	Stock Code
100MM X 280MM X 80 GRIT	GYPROCP80
100MM X 280MM X 100 GRIT	GYPROCP100
100MM X 280MM X 120 GRIT	GYPROCP120



ABRASIVE PAPER ROLLS

Description	Stock Code
115MM X 10M X 80 GRIT	P80ROLL
115MM X 10M X 100 GRIT	P100ROLL
115MM X 10M X 120 GRIT	P120ROLL
115MM X 10M X 180 GRIT	P180ROLL

WET AND DRY SHEETS AND SANDPAPER SHEETS

Description	Wet & Dry Stock Code	Sandpaper Stock Code
230MM X 280MM 40GRIT		SAND40
230MM X 280MM 60GRIT		SAND60
230MM X 280MM 80GRIT		SAND80
230MM X 280MM 120GRIT	WDS120	SAND120
230MM X 280MM 180GRIT	WDS180	SAND180
230MM X 280MM 240GRIT	WDS240	SAND240
230MM X 280MM 280GRIT	WDS280	
230MM X 280MM 320GRIT	WDS320	
230MM X 280MM 400GRIT	WDS400	
230MM X 280MM 500GRIT	WDS500	
230MM X 280MM 600GRIT	WDS600	
230MM X 280MM 800GRIT	WDS800	
230MM X 280MM 1000GRIT	WDS1000	
230MM X 280MM 1200GRIT	WDS1200	
230MM X 280MM 1500GRIT	WDS1500	
230MM X 280MM 2000GRIT	WDS2000	





CABLE TRAY

Description	Stock Code
50 MM LIGHT DUTY CABLE TRAY	50LD
100 MM MEDIUM DUTY CABLE TRAY	100MCT
150 MM MEDIUM DUTY CABLE TRAY	150MCT
225 MM MEDIUM DUTY CABLE TRAY	225MCT
300 MM MEDIUM DUTY CABLE TRAY	300MCT
450 MM MEDIUM DUTY CABLE TRAY	450MCT



CABLE TRAY ACCESSORIES

Description	100MM	150MM	225MM	300MM	450MM
45 DEGREE BEND	FB100	FB150	FB225	FB300	FB450
EQUAL TEE	FT100	FT150	FT225	FT300	FT450
INTERNAL RISER	IR100	IR150	IR225	IR300	IR450
EXTERNAL RISER	ER100	ER150	ER225	ER300	ER450
STAND OFFS	TSB100	TSB150	TSB225	TSB300	TSB450
OVERHEAD TRAY HANGERS	OHB100	OHB150	OHB225	OHB300	OHB450
CABLE TRAY COUPLERS	COUP				



HEAVY DUTY CABLE TRAY AND BASKET TRAY
AND ACCESSORIES ALSO AVAILABLE



CABLE TIES



Description	Stock Code
100mm Natural Cable Tie	CTW100
150mm Natural Cable Tie	CTW150
200mm Natural Cable Tie	CTW200
300mm Natural Cable Tie	CTW300
350mm Natural Cable Tie	CTW350
100mm Black Cable Tie	CTB100
150mm Black Cable Tie	CTB150
200mm Black Cable Tie	CTB200
300mm Black Cable Tie	CTB300
350mm Black Cable Tie	CTB350
20 x 20 Cable Tie Base White	CTB030
Masonry Cable Tie Mount	MTM

CABLE BOWS



Description	Stock Code
KB8 Single Cable Clasp	KB8
KB16 Double Cable Clasp	KB16
SF Plus KB8 Single Cable Clasp With PLUG	KB8SF
SF Plus KB16 Double Cable Clasp With PLUG	KB16SF

INSULATED PIPE CLIPS

Description	Stock Code	Boss Size
M12 - 15 Pipe Clamp	FGRS1215	8/10 mm
M15 - 19 Pipe Clamp	FGRS1519	8/10 mm
M20 - 24 Pipe Clamp	FGRS2024	8/10 mm
M25 - 30 Pipe Clamp	FGRS2530	8/10 mm
M32 - 37 Pipe Clamp	FGRS3237	8/10 mm
M40 - 45 Pipe Clamp	FGRS4045	8/10 mm
M48 - 53 Pipe Clamp	FGRS4853	8/10 mm
M54 - 58 Pipe Clamp	FGRS5458	8/10 mm
M59 - 63 Pipe Clamp	FGRS5963	8/10 mm



INSULATED PIPE CLAMPS (TWIN SCREW)

Description	Stock Code	Boss Size
M62 - 64 Pipe Clamps	FRS6264	8/10 mm
M68 - 73 Pipe Clamps	FRS6873	8/10 mm
M74 - 78 Pipe Clamps	FRS7478	8/10 mm
M80 - 86 Pipe Clamps	FRS8286	8/10 mm
M95 - 103 Pipe Clamps	FRS95103	8/10 mm
M108 - 116 Pipe Clamps	FRS108116	8/10 mm
M121 - 127 Pipe Clamps	FRS121127	8/10 mm
M133 - 141 Pipe Clamps	FRS133141	8/10 mm
M159 - 162 Pipe Clamps	FRS159162	8/10 mm



BACK PLATES

Description	Stock Code
M8/10 Duel Boss Back Plate	GPLM8

CHANNEL SUPPORT

Description	Stock Code
41 X 41 Plain Channel 3mtr	P1000
41 x 41 Slotted Channel 3mtr	P1000T
41 x 21 Plain Channel 3mtr	P3300
41 x 21 Slotted Channel 3mtr	P3300T
41 x 41 Light Guage Channel 3mtr	P1000TLG
41 x 21 Light Guage Channel 3mtr	P3300TLG
41 x 41 Plain Channel 6mtr	P10006
41 x 41 Slotted Channel 6mtr	P1000T6
41 x 41 Back to Back Channel 6mtr	P10016
41 x 21 Slotted Channel 6mtr	P3300T6
41 x 21 Back to Back Channel	P330016

CHANNEL NUTS

Description	Stock Code
M6 Long Spring Channel Nuts	CNL6
M8 Long Spring Channel Nuts	CNL8
M10 Long Spring Channel Nuts	CNL10
M12 Long Spring Channel Nuts	CNL12
M6 Short Spring Channel Nuts	CNS6
M8 Short Spring Channel Nuts	CNS8
M10 Short Spring Channel Nuts	CNS10
M12 Short Spring Channel Nuts	CNS12
M6 Plain Channel Nuts	CNP6
M8 Plain Channel Nuts	CNP8
M10 Plain Channel Nuts	CNP10
M12 Plain Channel Nuts	CNP12

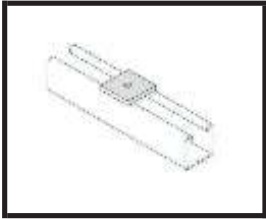

FB100/M6

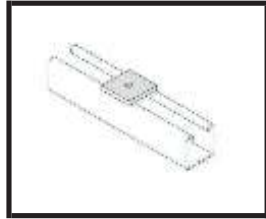

FB100/M83
FB100/M85



FB100/M103
FB100/M105

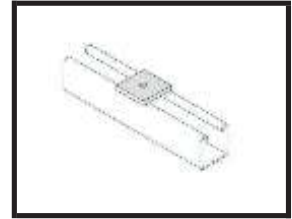

FB100/M12

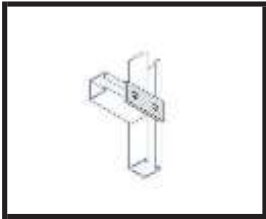

FB101

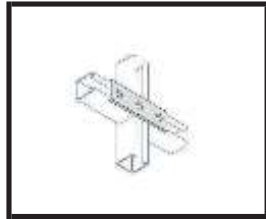

FB102

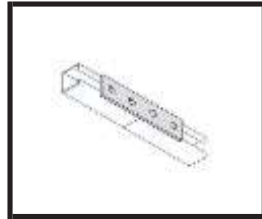

FB103

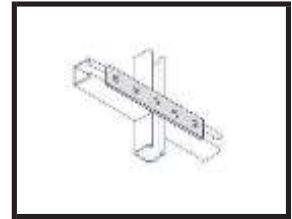

FB104

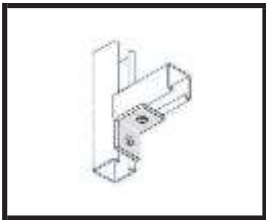

FB111

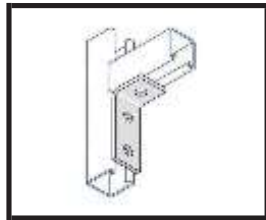

FB112

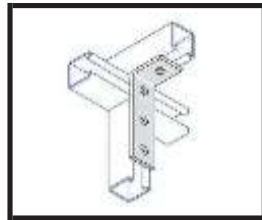

FB113A

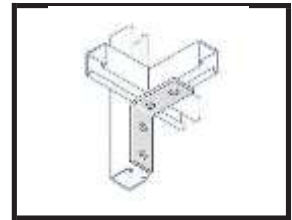

FB114



FB126

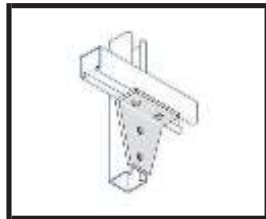

FB117



FB120

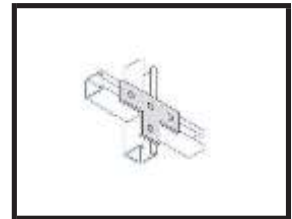

FB121



CBC10

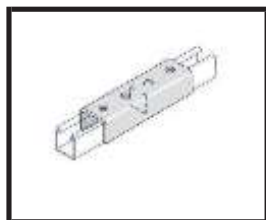

FB127/21



FB127/41



FB128

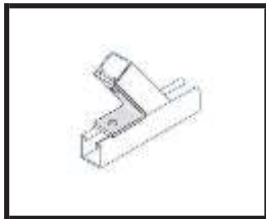

FB129



FB130

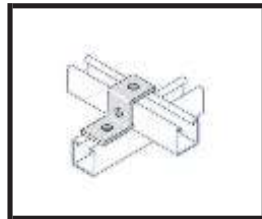

FB131

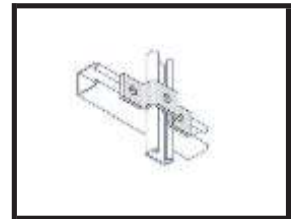

FB132

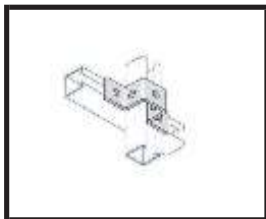

FB134

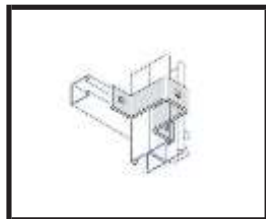

FB136

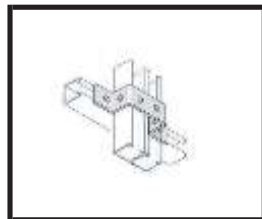

FB137



FB138



BC03 (41X41)

BC11 (41X21)

BC01 (41X82)

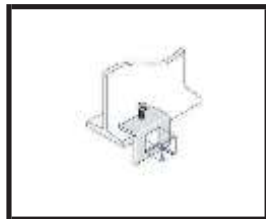

BC02 (41X41)

BC02A (41X21)

BC02B (41X82)



BC02/A

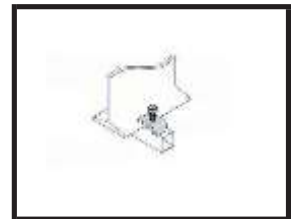

BC04

BC02

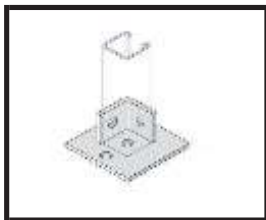

FB106

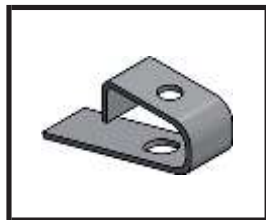

Purlin Clip

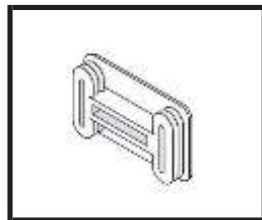

PVC1B

PVC1W

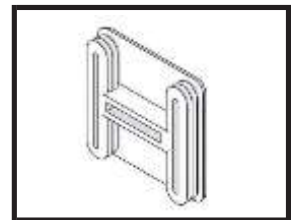

PVC2B

PVC2W

CARMS

150

300

450

600

750

750 BACK TO BACK

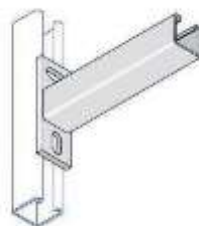



ROOF TOP BUILDING SERVICES SUPPORT SYSTEMS

Description	Stock Code
350 Base Support	BF350
500 Base Support	BF500
250mm Flexi Feet Support	DUFX250
400mm Flexi Feet Support	DUFX400
600mm Flexi Feet Support	DUFX 600
1000mm Flexi Feet Support	DUFX1000

CADDY CLIPS



PLEASE ASK FOR SEPERATE CLIP FASTENER CATELOGUE

GRIPPLE



Wire Rope Diameter	Max Vertical Load Rating
2mm	70KG
3mm	150KG
4mm	300KG
5mm	400KG
6mm	500KG
8mm	1000KG
10mm	1500KG

ADHESIVES



Description	Stock Code
1 LITRE WEATHERPROOF WOOD ADHESIVE	PVA1
5 LITRE WEATHERPROOF WOOD ADHESIVE	PVA2
5 LITRE PVA BOND	PVA06



GRIPFILL	PA01GF
GRIPFILL SOLVENT FREE	PA01SF



PINK GRIP	PAPINK
-----------	--------



STANDARD GUN A NAILS	PA01PGE
----------------------	---------



STIXALL EXTREME POWER	STIXC
-----------------------	-------



PRO STICK 2000	PROC
----------------	------



CT 1	CT1
------	-----



5 MINUTE PU ADHESIVE LIQUID 750ML POT	PU5750
---------------------------------------	--------



5 MINUTE PU ADHESIVE GEL 310ML MASTIC TUBE	PU5310
--	--------



1 LITRE CONTACT ADHESIVE	CA01
5 LITRE CONTACT ADHESIVE	CA05
500ML SPRAY CONTACT ADHESIVE	CSA



GATOR GLUE	GATORGLUE
50G INDUSTRIAL GRADE SUPERGLUE	SG02
MITREBOND KIT (SUPERGLUE & ACTIVATOR)	MBK
MULTISTICK	MULTISTICK

ADHESIVES



Description	Stock Code
DECORATORS CAULK C3 SIZE	DM02
CONTRACTORS LMA SILICONE	
WHITE LMA SILICONE	SIW
TRANS LMA SILICONE	SIC
BLACK LMA SILICONE	SIBL
GREY LMA SILICONE	SIG
BROWN LMA SILICONE	SIBR
FIRE MATE INTUMESCENT FIRE RATED ACCOUSTIC SEALANT C3 SIZE	FMS
JUMBO 900ML INTUMESCENT ACCOUSTIC SEALANT	IAS900
SEALANT GUN	SIG
JUMBO SEALANT GUN	IAS900G



EXPANDING FOAM

Description	Stock Code
B2 FIRE RATED HAND FOAM	EFUP
B2 FIRE RATED GUN FOAM	EFG
GUN FOAM CLEANER	EFC
APPLICATOR GUN	EFGUN



Description	Stock Code
GALVANISING SPRAY	GFS
CUTTING AND TAPPING FLUID SPRAY	AERCT
MAINTENANCE SPRAY	AERMS
WD 40	WD40



LINE MARKER SPRAY

Description	Stock Code
YELLOW	LMSY
RED	LMSR
BLUE	LMSB
WHITE	LMSW

ELECTRICIANS TAPE



Description	Stock Code
RED	PVCREG
BROWN	PVCBROWN
BLUE	PVCBLUE
GREEN	PVCGREEN
YELLOW	PVCYELLOW
BLACK	PVCBLACK
WHITE	PVCWHITE
GREEN / YELLOW	PVCGREENYELLOW

GAFFER TAPE



Description	Stock Code
50MM BLACK GAFFER TAPE	GAFB
50MM SILVER GAFFER TAPE	GAFS

MISCELLANEOUS TAPE



Description	Stock Code
25MM MASKING TAPE	MASK25
50MM MASKING TAPE	MASK50
50MM LOW TACK MASKING TAPE	MASK50LT



PLASTERERS SCRIM TAPE	SCRIM
PAPER JOINTING TAPE	PJTAPE



ALI FOIL TAPE	
50 MM ALI FOIL TAPE	ALI50
75 MM ALI FOIL TAPE	ALI75
100 MM ALI FOIL TAPE	ALI100



BARRIER TAPE	
RED AND WHITE 75 MM WIDE HAZARD STRIPE	HZ01
YELLOW AND BLACK 75 MM WIDE HAZARD STRIPE	HZ02

SAFETY WEAR

Description	Stock Code
LATEX GLOVES	LATEX
COLOUR CODED POLY GLOVES	
RED CUT LEVEL 1	PCNRED
AMBER / ORANGE CUT LEVEL 3	PU3000
GREEN CUT LEVEL 5	PU500
MULTI GLOVES	MULTIXL
WHITE STOCKINETTE COTTON GLOVES	WCG
THERMAL GLOVES	TG006
ORANGE LATTICE GLOVES	CCG
KEVLAR 22" SLEEVES	SLEEVE
HARD HATS	HAT

EYE PROTECTION	
SAFETY SPECTACLES (CLEAR)	SPEC
BOLLE PREMIUM SAFETY SPECTACLES (CLEAR)	BOHLEC
BOLLE PREMIUM SAFETY SPECTACLES (SMOKE)	BOHLES
SAFETY GOGGLES	GOG

EAR DEFENDERS	EAR
FOAM EAR PLUGS	EARPLUG

P1 CUP FACE MASK	CFM
P2 CUP FACE MASK	FFP2
FFP3 VALVED FACE MASK	FFP3
755 RUBBER HALF MASK C/W TWIN FILTERS	755MASK





SAFETY WEAR

Description	Stock Code
HIGH VIS VESTS	HVV
DISPOSABLE PAPER SUITS	DPS
SAFETY HARNESS	HARNESS
LANYARD	LANYARD
SAFETY BOOTS MOST TYPES AVAILABLE INC. DEWALT CHUCKA TYPE	SB006
RIGGER BOOT	SB006
SAFETY TRAINER	SB010
TRUCKER TYPE	SB012



PADLOCKS AND CHAIN

Description	Stock Code
BRASS PADLOCKS	
38MM BRASS PADLOCK	BP112
50MM BRASS PADLOCK	BP2
65 M BRASS PADLOCK	BP212
50MM BRASS PADLOCK KEYED ALIKE	KX159KA
50MM BRASS COMBINATION PADLOCK	CPL
DISCUS PADLOCK	
70MM ST/STEEL DISCUS PADLOCK	DP80
70MM ST/STEEL DISCUSCOMBINATION PADLOCK	DP70CL
MANY OTHER PADLOCK AVAILABLE	
6 X 33MM GALV CHAIN	GC
SITE SAFE 4 X 2 X 2	422
VAN VAULT	VAN

FIRE EXTINGUISHERS

Description	Stock Code
IKG POWDER	
OTHER SIZES AVAILABLE ALSO WATER, CO2, FOAM AND POWDER	FIRE1KG

LADDERS



Description	Stock Code	Top Tread Height (M)	Reach Height (M)
FIBREGLASS LADDERS			
5 TREAD FIBREGLASS STEP LADDER	STEP5F	1.4	2.31
6 TREAD FIBREGLASS STEP LADDER	STEP6F	1.67	2.59
8 TREAD FIBREGLASS STEP LADDER	STEP8F	2.23	3.15
10 TREAD FIBREGLASS STEP LADDER	STEP10F	2.79	3.7



ALUMINIUM STEP LADDERS			
5 TREAD ALUMINIUM STEP LADDER	STEP5A	1.06	1.93
6 TREAD ALUMINIUM STEP LADDER	STEP6A	1.27	2.14
7 TREAD ALUMINIUM STEP LADDER	STEP7A	1.49	2.35
8 TREAD ALUMINIUM STEP LADDER	STEP8A	1.69	2.56
10 TREAD ALUMINIUM STEP LADDER	STEP10A	2.1	2.98
12 TREAD ALUMINIUM STEP LADDER	STEP12A	2.52	3.39



HOP UPS	
600 X 600 HOP UP	HOPUPS600



SCAFFTAG KIT	SCAFF
SCAFFTAG INSERTS	SCAFFLAB
LADDERTAG	LADDERTAG
LADDERTAG INSERTS	LADLAB

SITE ELECTRICAL EQUIPMENT



Description	Stock Code
110V PLUG	PLUG
110V SOCKET	SOCK



14 METRE TRAILING LEAD 110V	EXT14
25 METRE 110V CABLE REEL	CABLE110
50 METRE 240V CABLE REEL	CABLE240
3 KVA TRANSFORMER	TRAN3
3.3 KVA TRANSFORMER	TRAN33A
5 KVA TRANSFORMER	TRAN5



3 WAY SPLITTER	FPPSOCK3WAY
4 WAY DISTRIBUTION BOX	JB4



FOLDING PLASTERERS LIGHT	FFPSLFWL
SINGLE LED TRIPOD LIGHT	FFPSSLED30TL
DOUBLE LED TRIPOD LIGHT	FFPSSLED60TL



FLOURESCENT TASK LIGHT	TASK
LED RECHARABLE WORK LIGHT	COBLED

IRONMONGERY



Description	Stock Code
6 " BZP TEE HINGES	TH6
8 " BZP TEE HINGES	TH8
10 " BZP TEE HINGES	TH10
18 " BZP TEE HINGES	18MTHBZP



6 " BRENTON PADBOLTS	BPB
4 " TOWER BOLT	BTB4
6" TOWER BOLT	6BTB



SUFFOLK LATCH	SUFF
RING GATE LATCH	RGL6



4 1/2" HASP AND STAPLE	HASP4
6" HASP AND STAPLE	HASP6
8" HASP AND STAPLE	HASP8

PAINT BRUSHES



Description	Stock Code
1/2" PAINT BRUSH	PB12
1" PAINT BRUSH	PB12
1 1/2" PAINT BRUSH	PB112
2" PAINT BRUSH	PB2
3" PAINT BRUSH	PB3
4" PAINT BRUSH	PB4

DUST SHEETS, TARPAULIN, RUBBLE SACKS

Description	Stock Code
DUST SHEETS 3.1 M X 2.4 M HEAVY COTTON	DUST
POLYTHENE DUST SHEETS 3.6 M X 3.6 M (3s)	STA129285
TARPAULIN 3.6 M X 5.4 M	TARP
RUBBLE SACKS (100s)	RUBBLE

BROOMS

Description	Stock Code
12 " SOFT BROOM	SBROOM12
12 " STIFF BROOM	STBROOM12
24 " SOFT PLATFORM BROOM	SBROOM24
24 " STIFF PLATFORM BROOM	PBROOM24
DUST PAN AND BRUSH	DUSTPAN
WONDERWIPES (100s)	WIPES



MISCELLANEOUS



Description	Stock Code
METAL SHOVEL AND BRUSH	MSB
BUILDERS TUB	BUILDTUB
BUILDERS BUCKET	BUCKET
CONTRACTORS BIN	CBIN

VISQUEEN ZEDEK DPC



150mm x 20mm	VISQZX15020	
300mm x 20mm	VISQZX30020	
450mm x 20mm	VISQZX45020	
600mm x 20mm	VISQZX60020	
1000mm x 20mm	VISQZX100020	

POLYTHENE SHEET



500 guage	25m x 4m sheet	POLY500
1000 guage	25m x 4m sheet	POLY1000
1200 guage	25m x 4m sheet	POLY1200

A	
Abrasive Discs	60
Abrasive Rolls	61
Adhesives	69
Alpha Wedge	12
Aluminum Foil Tape	72
Angle Brackets	46
Anker Bolts	7
Anchors	
Anker Bolts	7
chemical fixings	14 / 15
Drop In	11
Heavy Duty	9
Rawl Bolts	10
Resin	14/15
Shield Anchors	10
Sleeve Anchors	9
Through bolts	8
B	
Back Plates	64
Barrier Tape	72
Big Foot System	68
Blacksmith Drill Bit	53
Bolts	
Coach Bolts	37
H.T XoX Bolt	39
Roofing Bolt	40
Set Screw	38
Bolts	
Brenton	77
Tower	77
Boots	74
Brass Wood screw	25
Brooms	78
Buckets	71
C	
Cable bows	63
Cable Reels	76
Cable Ties	63
Cable trays	64
Carriage Bolts	37
Cartridge Tool	18
Cavity Anchor	2
Ceiling Anchor	5
Chain	74
Channel Brackets	66/67

Channel Nuts	65
Channel Support	65
Chemical Fixings	14/15
Chemical Studs	15
Chippy Screws	22
Chisels SDS	48
Chucks	53
Circle Drywall Discs	60
Circular Saw Blades	58
Coach Bolts	37
Coach Screws	36
Cobalt Hss Drill Bits	52
Concrete Screw	6
Cone Cutters	53
Countersunk Bits	53
D	
Diamond Blades	60
Diamond Core bits	49
Diamond Mini Core Bits	50
Dome Nuts	41
Drill Bits	
Blacksmith	52
Broaching	53
Cobalt HSS	53
Diamond	49/50
HSS	51
Magdrill	53
Rebar Bits	48
SDS	47
SDS Max	48
Tile & Glass	50
Wood Auger	55
Wood Flat Bit	55
Driva	2
Drop-In Anchors	11
Drywall Disc	61
Drywall Screws	30/31
Dust Bin	79
Dust Mask	73
Dust Pan & Brush	77
Dust Sheet	77
E	
Ear Defenders	73
Ear Plugs	73
Electrical Tape	72
Electricians Hole saw	54

Evolution Saw Blades	59
Expanding Foam	71
Extension Leads	76
F	
Fire Extinguishers	74
Fire-fix Clips	17
Flange Nuts	42
Frame Fixings	6
G	
Gaffer Tape	72
Galvanizing Spray	71
Gas - Pulsa Tool	16
Gate Latch	77
Glasses Safety	73
Gloves	73
Goggles Safety	73
Gripple	68
Gun Foam	71
H	
Hacksaw Blades	57
Hacksaw Blade Junior	57
Hammer Screw	3,4
Handsaw	5
Hard Hats	6
Harness Safety	74
Hasp & Staples	77
Hilti DX Type Pins & Cartridge	19
Hinges Tee	77
Holesaws	54
Hop-ups	75
HSS Drill Bits	51
Hss Cobalt Drill Bits	52
I	
Index Screws	35
Ironmongery	77
Insulation Anchors	3
Insulation Panel Fix	4
Insulation Screws	5
Insulation Washers	6
J	
Jigsaw Blade	56
Joist Hangers	45
L	
Ladders	75
Line Marker Spray	71
M	
Machine Screws	40

Magdrill Bits	53
Masking Tape	72
Masks Safety	73
Masonry Nails	4
Mini Diamond Core Bits	50
Multi Wedge	2
N	
Nail Ins	5
Nails Masonry	4
Nails Wire	44
Nuts	
Dome	41
Flange	42
Half	41
Nyloc	41
Nutserts	42
P	
Packing Shrins	35
Padlocks	74
Paint Brushes	78
Panel Adhesive	69
Panel Fix	3
Pancake Screws	32
Panel Pins	44
Paper Tape	72
Paslode Nails	20
R	
Rage Blades	51
Ramnuts	13
Rawlbolts	10
Rawlnuts	13
Rebar Bits	5
Redhead Anchors	11
Recipricating saw Blades	56
Resin Fixings	14
Restraint Straps	46
Rivets	8
Rod Hangers	7
Roofing Bolts	40
Roofing Top Building Support	68
Roundhead Wood screws	24
Rubber Nuts	13
Rubble Sacks	78
S	
Safety Wear	73,74
Saw Blades	
Circular	58

Diamond	60
Evolution	51
Hacksaw	57
Jigsaw	56
Junior Hacksaw	57
Rage	59
Recipricating	56
Screws	
Chippy	22
Cementatious Screw	32
Drywall	30/31
Insulation	4
Self Tappers	27
Stainless Steel	26
Super twin Wood screw	23
Tough board	32
Ultimate	21
Screw Cups	28
Screw Driver Bits	29
Scrim Tape	72
SDS Drill Bits	47
SDS Max Drill bits	48
SDS Points	48
Self Tapping Screws	27
Set Bolts	38
Shake proof Washers	42
Shear Nuts	41
Shield Anchors	10
Silicon	70
Site Lighting	76
Site Safe	74
Sleeve Anchor	9
Slim Deck	12
Spit Cartridge Tool	18
Spit Pulsa Tool	18
Spring Toggle	2
Spring Washer	43
Staple & Staple gun	28
Stepdrill	53
Stud Connectors	13
Studding	13
Sure twist Nails	3
T	
Table Stretcher Plate	28
Tap-con Screws	6
Taps	52

Tapes	72
Tek Screws	
Counter Sunk	34
Gash Point	35
Hex Head	33
Through Bolts	8
Threaded Rod	13
Timber Connectors	42
Timberlock Screws	35
Toggles	2
Toughboard Screw	32
TR60	12
Transformers	76
U	
Ultimate Screws	21
V	
Vine Eyes	5
Visqueen Zedek	79
W	
Washers	43
Insulation	4
Penny	43
Shake proof	43
Spring	43
Square Plate	42
WD40	71
Wedge Nuts	12
Wet & Dry Paper	61
Wing Nuts	4
Wipes	78
Wire hanger	5
Wood Bits -Auger	55
Wood Bits - Flat	55
Wire hanger	5
Wood Bits -Auger	55
Wood Bits - Flat	55
Wood Screws	
Brass	25
Chippy	22
High Proformance	21
Self Tapping	27
Stainless Steel	26
Super twin	23
Ultimate	21
Square Twist Nail	44

A C FIXINGS LTD

Unit 8 Buckingham Court, Dairy Road, Dukes Park
Industrial Estate, Chelmsford, Essex CM2 6XW

Telephone: 01245 451234
Web: www.acfixingsltd.co.uk

Facsimile : 01245 451701
acfixingsltd@btconnect.com